

AJMAL MAKAN CITY

Sharjah Waterfront



مدينة أجمل مكان

واجهه الشارقة المائية



AJMAL MAKAN CITY



800 42 666
www.ajmalmakan.com



- | | | | |
|---|------------------|---|-------------------|
| 1 | Villas | 1 | فلل |
| 2 | Hotels | 2 | فنادق |
| 3 | Hospitals | 3 | مستشفيات |
| 4 | Shopping Mall | 4 | مول |
| 5 | School | 5 | مدرسة |
| 6 | Water Theme Park | 6 | مدينة ألعاب مائية |
| 7 | Marina | 7 | مارينا |



7
BEDROOM



6
BEDROOM



5
BEDROOM



4
BEDROOM

Ground Floor

First Floor

Second Floor



Ground Floor Area : 2,193.79 ft² - 203.81 m²
 First Floor Area : 2,219.95 ft² - 206.24 m²
 Second Floor Area : 706.11 ft² - 65.60 m²
 Total Area : 5,119.96 ft² - 475.66 m²

Ground Floor

First Floor

Second Floor



Ground Floor Area : 2,019.52 ft² - 187.62 m²
 First Floor Area : 2,069.90 ft² - 192.30 m²
 Second Floor Area : 644.22 ft² - 59.85 m²
 Total Area : 4,734 ft² - 440 m²

Ground Floor

First Floor

Second Floor

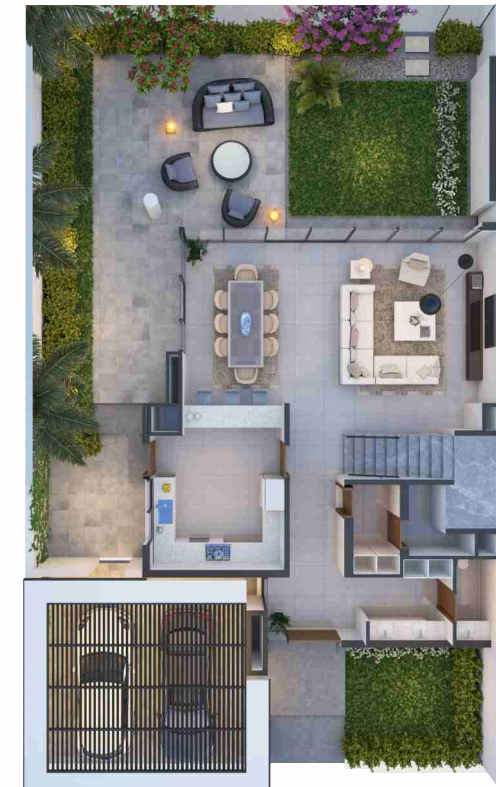

Ground Floor Area : 1,516.53 ft² - 140.89 m²
 First Floor Area : 1,613.62 ft² - 149.91 m²
 Second Floor Area : 668.87 ft² - 62.14 m²
 Total Area : 3,799 ft² - 353 m²

Ground Floor

First Floor

Second Floor

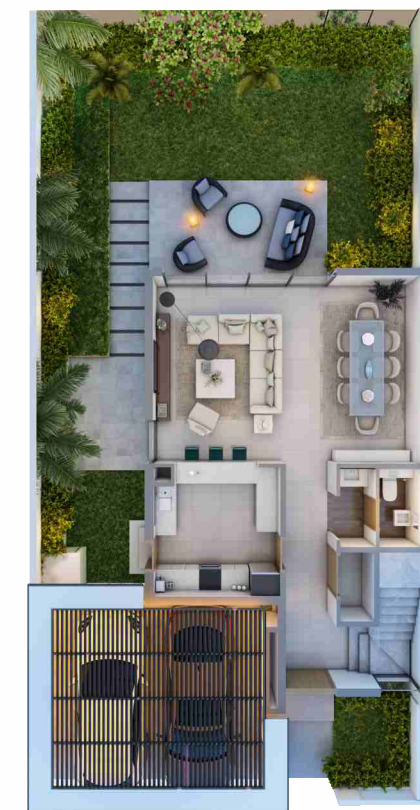

Ground Floor Area : 1,052.50 ft² - 97.78 m²
 First Floor Area : 1,110.94 ft² - 103.21 m²
 Second Floor Area : 610.53 ft² - 56.72 m²
 Total Area : 2,773.97 ft² - 258 m²

