

HAMILTON
RESIDENCY
BUSINESS BAY



Home and office next door!

In the heart of Business Bay, Dubai's prestigious corporate hub, is a haven of comfort and luxury. A residential address specially created for a successful person like you, who gives it a hundred percent at work, but will not compromise on quality time with the family.

Get the best of both worlds. Easy accessibility between home and work. The time you spend caught in traffic commuting to and from work, can now be spent in the swimming pool with your children. Or, enjoying a quiet dinner at home! And, when a meeting comes up unexpectedly, you know you're just a hop away!



BURJ DUBAI

DUBAI MALL

NEW DUBAI
DOWNTOWN

AL KHAIL ROAD

HAMILTON
RESIDENCY
BUSINESS BAY



Hamilton Towers Home and office next door!

- Faces scenic lake views and landscape development.
- In close proximity to Burj Dubai "The Worlds Tallest Tower" and Dubai Mall having a massive shopping center entrenched with 5 star property.
- Few minutes from Al Khail Road.



- 16 floors of well planned apartments • 1 bedroom apartments
- Designed to exacting European standards • Superior fixtures and finishes in every room
- State-of-the-art facilities and amenities





Get quality time at home and work



With life getting hectic day after day, you probably find that work makes unreasonable demands on your time, leaving you feeling stretched and stressed. Having a home close to your office helps you strike the right balance. So you can work hard and play hard!

You can now enjoy all the good things of life that you never found time for. Catch up with friends, unwind with music, indulge in outdoor activities with the children, go shopping, get a taste of the new restaurants in town... all this, within easy distance of your home.



State-of-the-art amenities
to compliment your lifestyle



Facilities available round the clock
to help you unwind

- Roof (Podium Level) Garden with Swimming Pool, Spa, Outdoor sitting & B.B.Q. area
 - Multi-purpose Hall/Aerobics
 - Fully equipped Gymnasium
 - Squash Court
 - Sauna, Steam and Lockers.
 - 24-hours Security system
 - CCTV system
- High Speed Internet connectivity
 - Access Control system
 - Central Air-conditioning
 - Fire Alarm system



The look that makes a statement



Stylish detailing and user friendly finishes make the difference

	Floor	Walls
Ground Floor		
Entrance Lobby	Granite/ Marble	Granite/ Marble
Typical Floor		
Lift Lobby/ Corridor	Granite/ Marble	High Quality Paint Finish
Living/ Dining	Quality Tiles	High Quality Paint Finish
Bed Rooms	Quality Tiles	High Quality Paint Finish
Kitchen	Quality Tiles	Quality Tiles
Toilets	Quality Tiles	Quality Tiles

Kitchen : Furnished with Cabinets, Granite Counter Top and set Stainless Steel Sink.

Bed Room : Furnished with Built-in Closets.

Toilet : Furnished with Fixtures & Granite Counter.

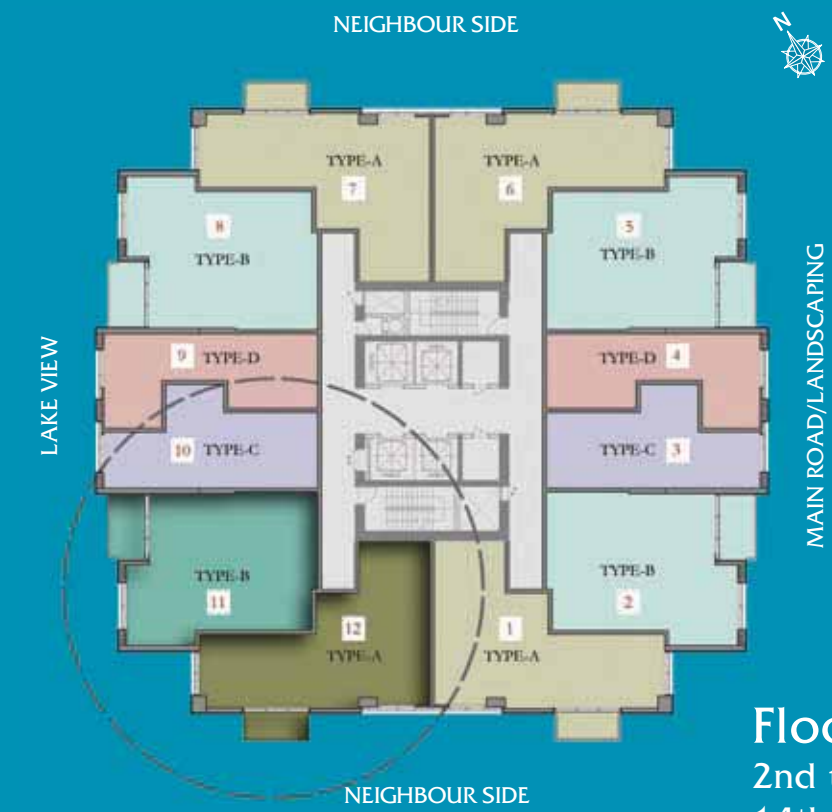

Floor Plan
 2nd to 12th Floor
 14th to 16th Floor
 1 Bedroom Apartments

Type B
 One Bedroom Apt.
 87.14 sq.mt
 937.94 sq.ft
 Apt. Nos. 2,5,8 & 11



Type A
 One Bedroom Apt.
 86.55 sq.mt
 931.69 sq.ft
 Apt. Nos. 1,6,7 & 12



Apartment Type	Space Name & Areas	Space Name & Areas				
		Living/Dining	Master Bed Room	Kitchen	Balcony	
Type A One Bed Room Apartment	6.00x3.95	3.70x4.30	2.40x2.7	5.25 sq.mt	Meters	
	19.69x12.96	12.14x14.11	7.87x8.86	56.51 sq.ft	Feet	
Type B One Bed Room Apartment	6.90x4.30	4.50x3.70	2.90x2.10	7.58 sq.mt	Meters	
	22.64x14.11	14.76x12.14	9.51x6.89	81.59 sq.ft	Feet	

Note: Dimensions are approximate due to space/walls orientation

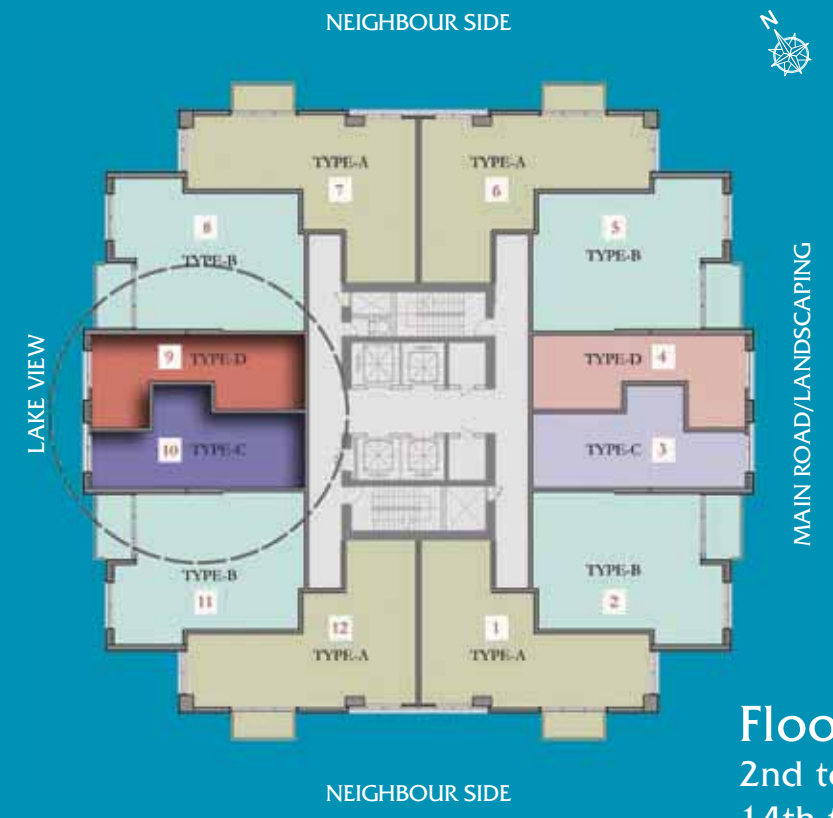

Floor Plan
 2nd to 12th Floor
 14th to 16th Floor
 1 Bedroom Apartments

Type D
 One Bedroom Apt.
 49.51 sq.mt
 532.91 sq.ft
 Apt. Nos. 4 & 9



Type C
 One Bedroom Apt.
 52.27 sq.mt
 562.62 sq.ft
 Apt. Nos. 3 & 10

Apartment Type		Space Name & Areas			
		Living/Dining	Master Bed Room	Kitchen	Balcony
Type C	One Bed Room Apartment	6.50x3.00	3.10x2.50	2.30x2.70	Meters
		21.33x9.84	10.17x8.20	7.54x8.86	Feet
Type D	One Bed Room Apartment	6.60x2.50	3.10x2.50	2.20x2.70	Meters
		21.65x8.20	10.17x8.20	7.22x8.86	Feet

Note: Dimensions are approximate due to space/walls orientation