

FLOOR PLAN LAYOUT

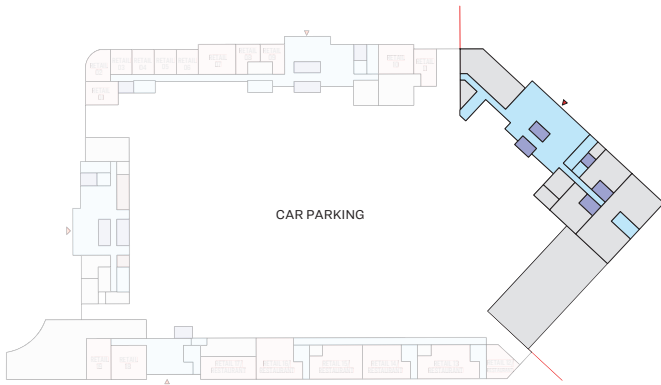

GROUND LEVEL

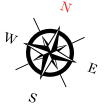
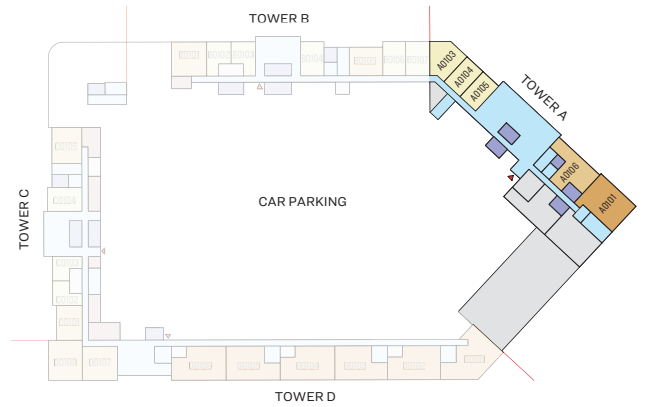

LEVEL-01(PODIUM 01)

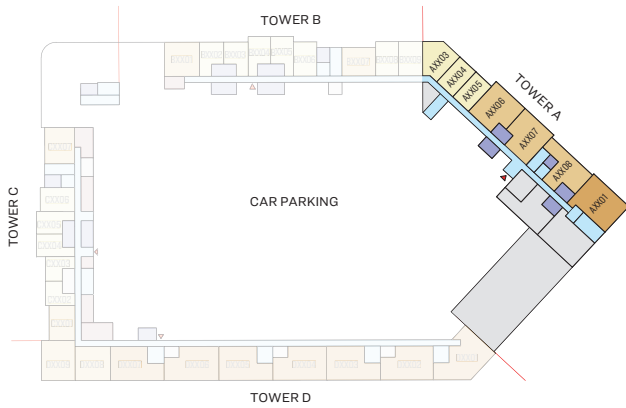

LEVEL-02,03 (PODIUM 02,03) TYPICAL FLOOR PLAN

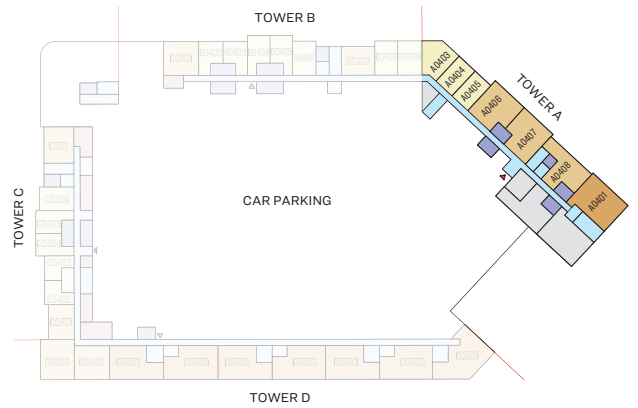

LEVEL-04(PODIUM 04)

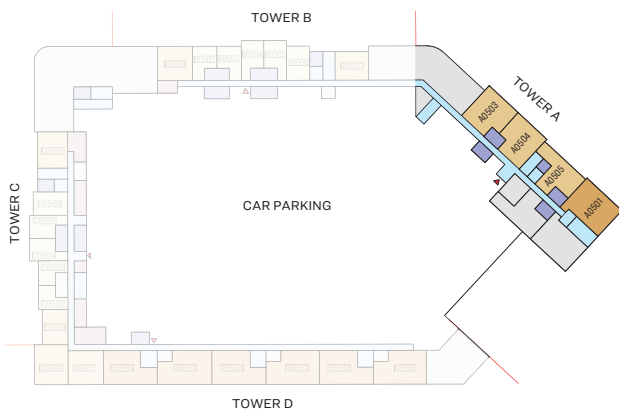

LEVEL-05(PODIUM 05)

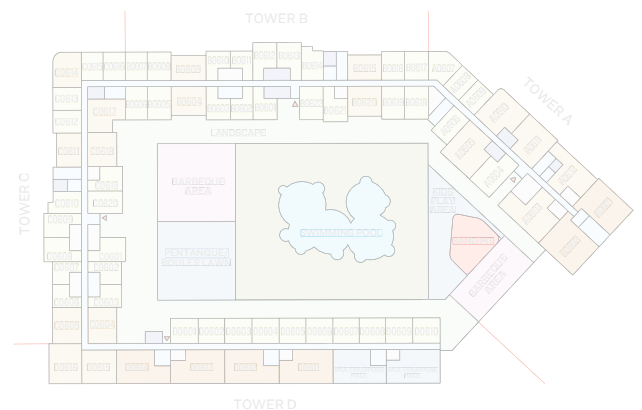

LEVEL-06

- | | | | |
|--|---|---|--|
| 1 BED UNIT | SERVICES | COMMERCIAL | BARBEQUE AREA |
| 2 BED UNIT | LIFT | LANDSCAPE | SWIMMING POOL DECK |
| 3 BED UNIT | AMENITIES | SWIMMING POOL | |
| LOBBIES,CORRIDORS & STAIRS | APARTMENT STORE | SAND PIT | |

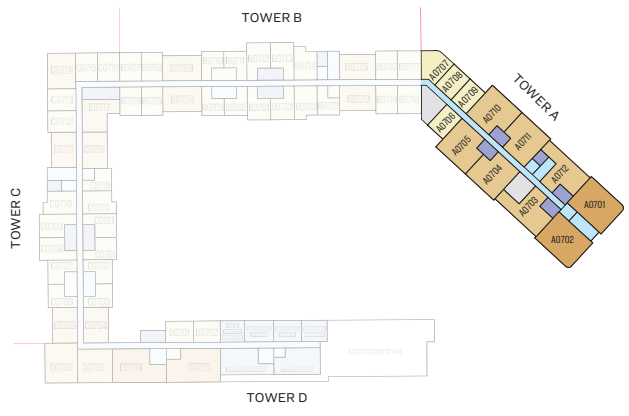
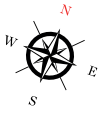

LEVEL-07

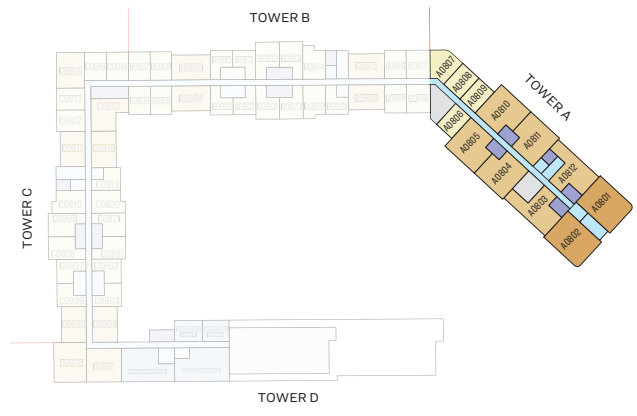

LEVEL-08

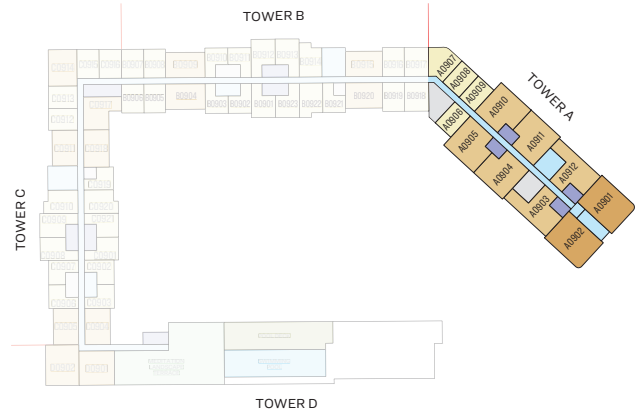

LEVEL-09

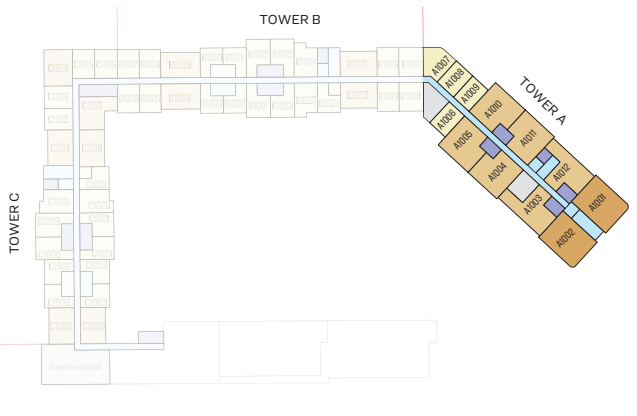

LEVEL 10

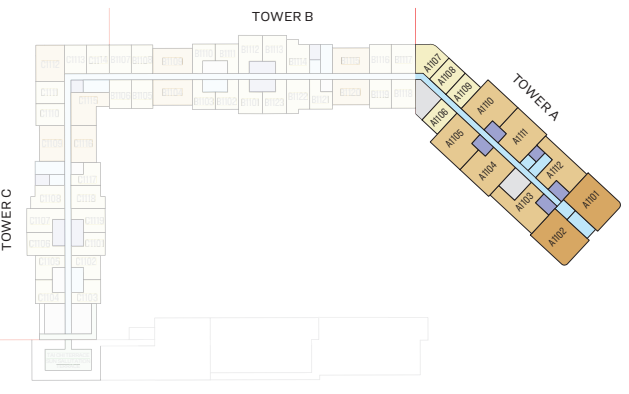

LEVEL 11

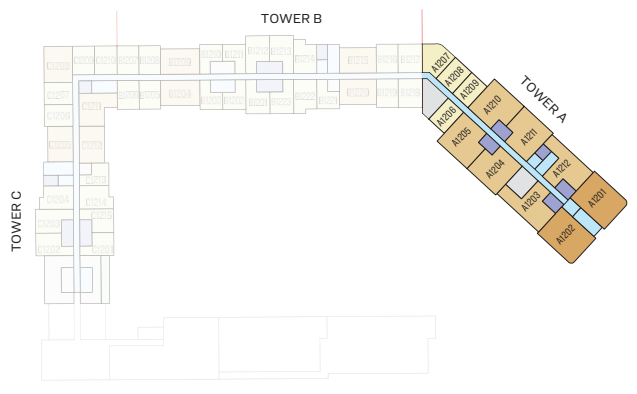

LEVEL 12

- 1 BED UNIT
 - 2 BED UNIT
 - 3 BED UNIT
 - LOBBIES,CORRIDORS & STAIRS
- SERVICES
 - LIFT
 - AMENITIES
 - LANDSCAPE
- SWIMMING POOL
 - SWIMMING POOL DECK

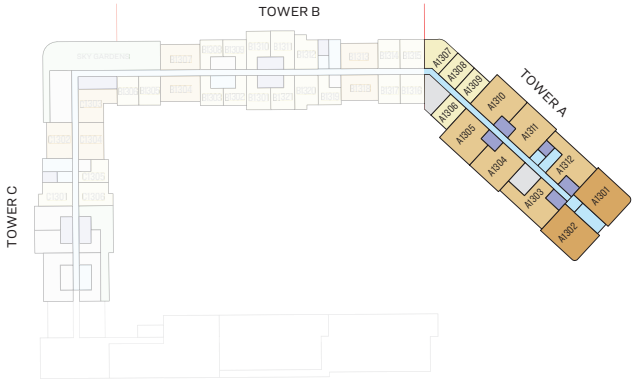
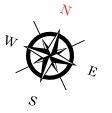

LEVEL 13

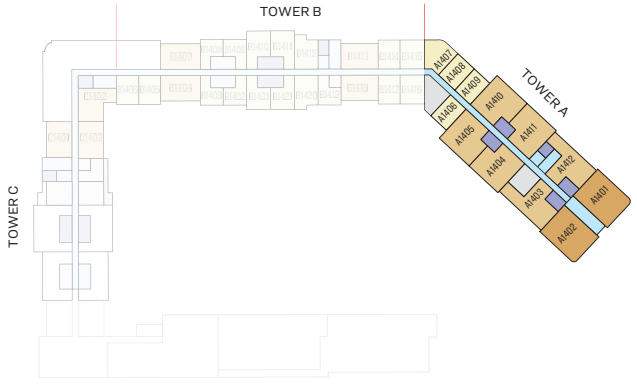

LEVEL 14

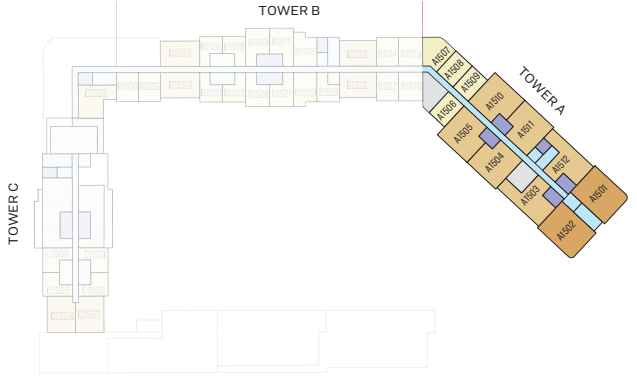

LEVEL 15

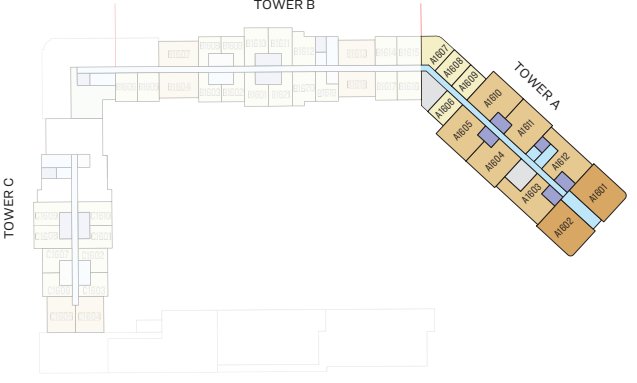

LEVEL 16

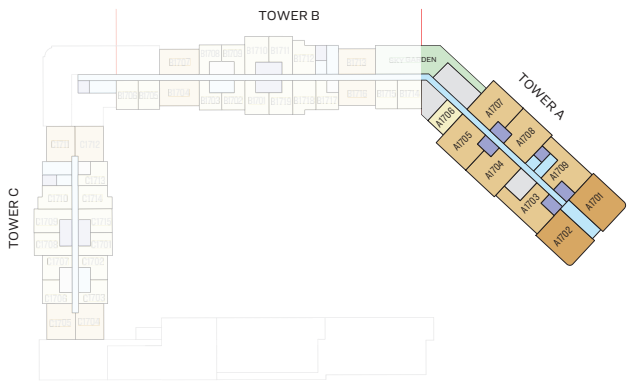

LEVEL 17

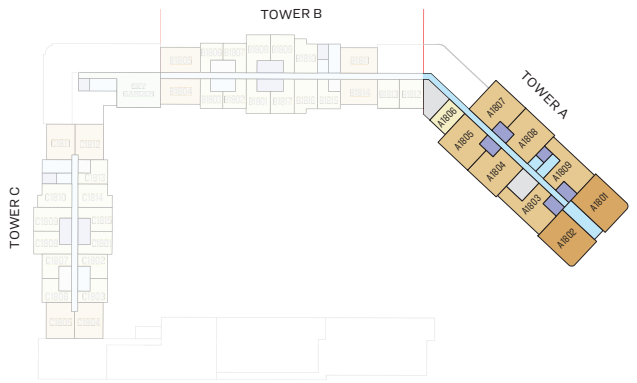

LEVEL 18

- | | |
|--|--|
| 1 BED UNIT | SERVICES |
| 2 BED UNIT | LIFT |
| 3 BED UNIT | AMENITIES |
| LOBBIES, CORRIDORS & STAIRS | LANDSCAPE |

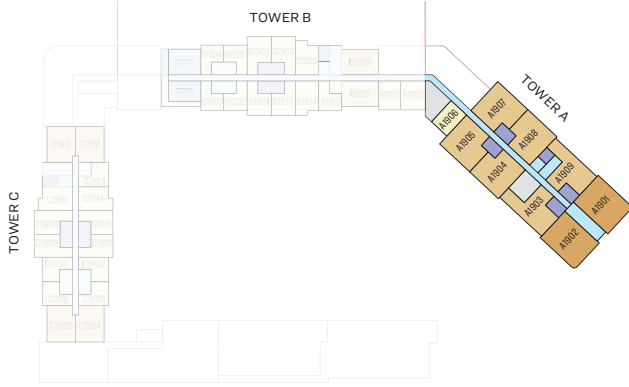
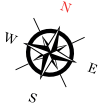

LEVEL 19

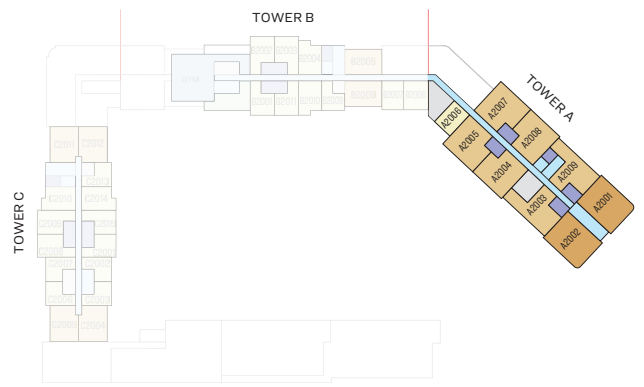

LEVEL 20

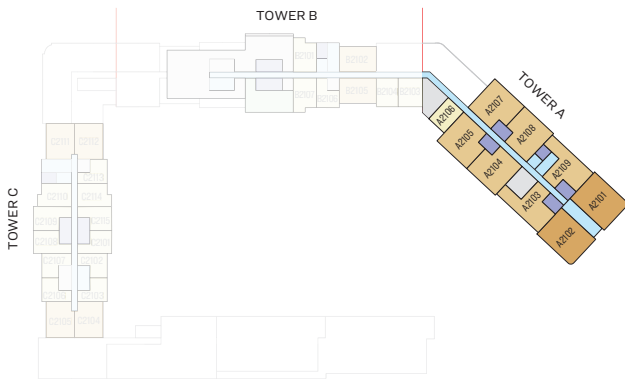

LEVEL 21

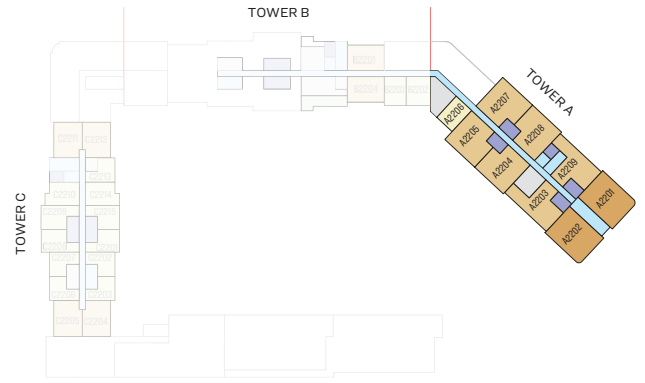

LEVEL 22

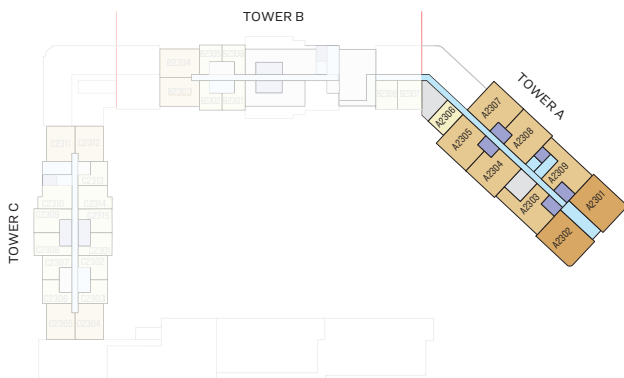

LEVEL 23

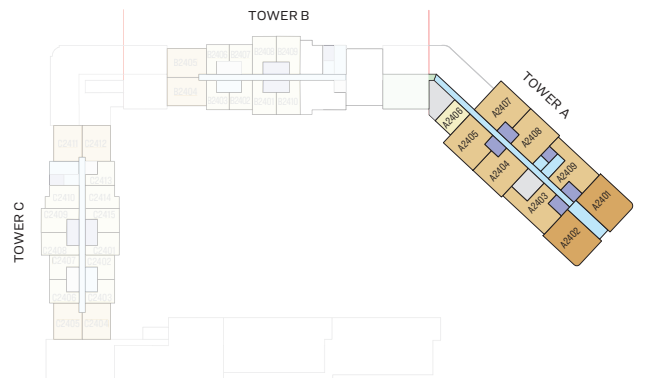

LEVEL 24

- | | |
|-----------------------------|-----------|
| 1 BED UNIT | SERVICES |
| 2 BED UNIT | LIFT |
| 3 BED UNIT | AMENITIES |
| LOBBIES, CORRIDORS & STAIRS | LANDSCAPE |

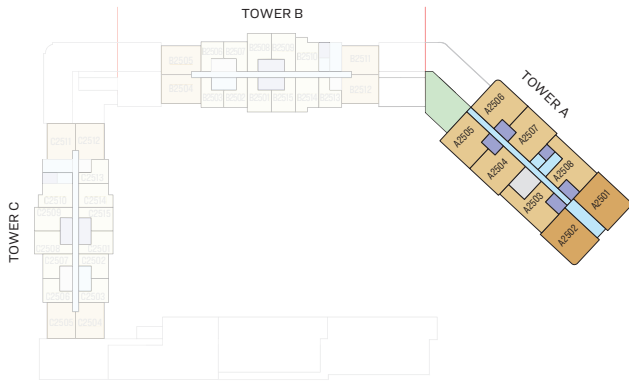
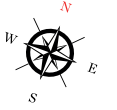

LEVEL 25

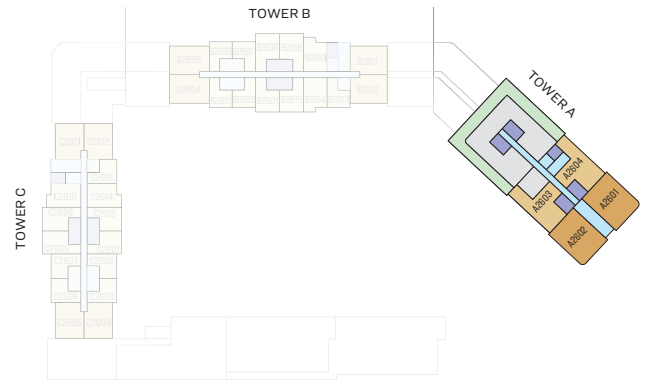

LEVEL 26

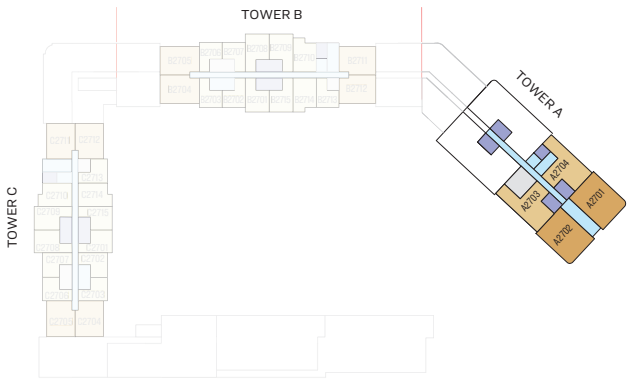

LEVEL 27

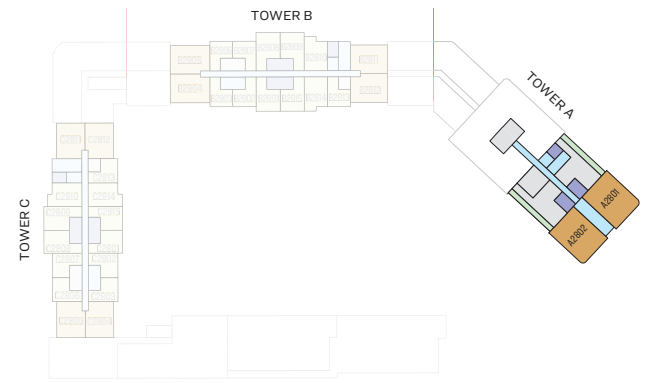

LEVEL 28

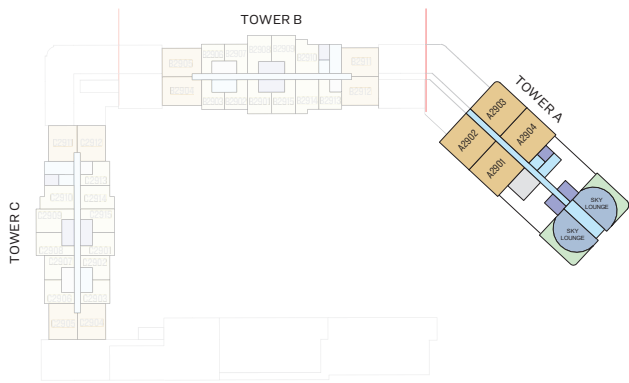

LEVEL 29

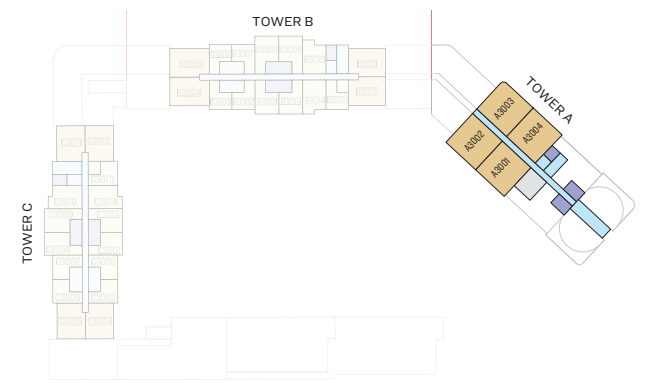

LEVEL 30

- 1 BED UNIT
- 2 BED UNIT
- 3 BED UNIT
- LOBBIES, CORRIDORS & STAIRS
- SERVICES
- LIFT
- AMENITIES
- LANDSCAPE

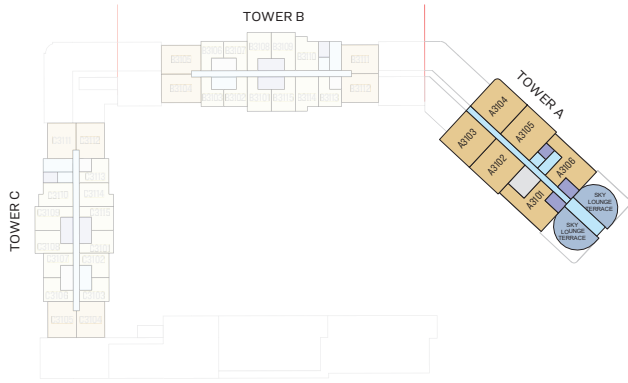
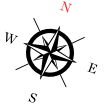

LEVEL 31

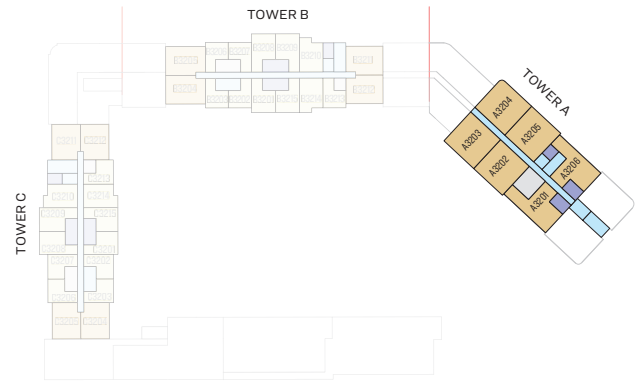

LEVEL 32

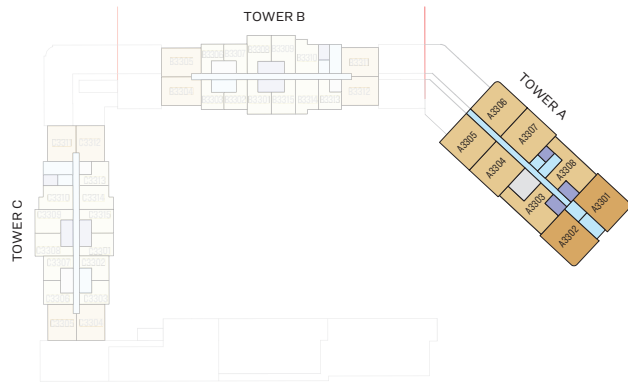

LEVEL 33

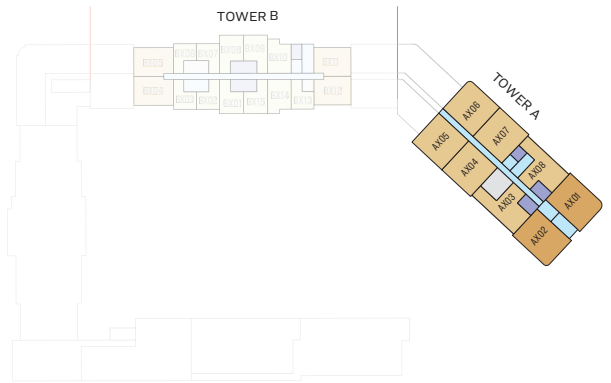

1 BEDROOM APARTMENT

TYPE A (with powder room + balcony)

TOTAL SALEABLE AREA

SUITE = 528.83 SQ.FT.
BALCONY = 44.24 SQ.FT.
TOTAL = 573.07 SQ.FT.

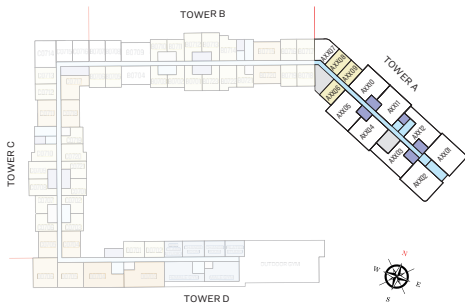

LEVEL 07-16 & 17-24

UNIT

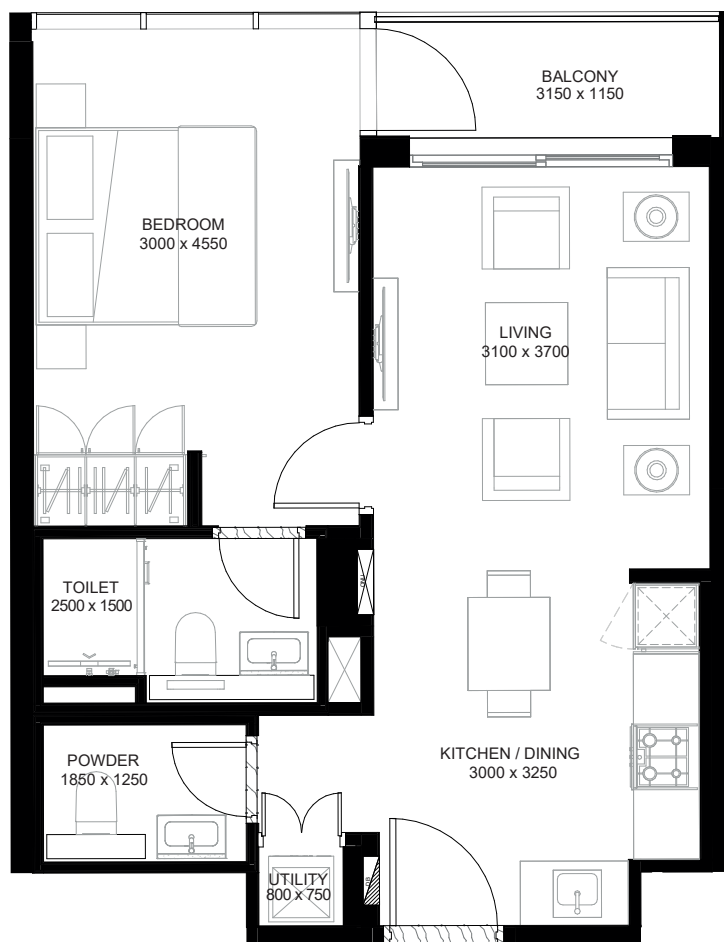

List of unit numbers with this unit plan:

VIEWS

Amenities

A0706, A0806, A0906, A1006, A1106

Amenities, Waterfront

A1206, A1306, A1406, A1506, A1606, A1706, A1806, A1906, A2006, A2106, A2206, A2306, A2406

Downtown, Sports Court, Ras Al Khor

A0708*, A0709*, A0808*, A0809*, A0908*, A0909*, A1008*, A1009*, A1108*, A1109*, A1208*, A1209*, A1308*, A1309*, A1408*, A1409*, A1508*, A1509*, A1608*, A1609*

* These apartments have mirrored units plans of the above

1 BEDROOM APARTMENT

TYPE A1 (with powder room + balcony)

TOTAL SALEABLE AREA

SUITE = 568.73 SQ.FT.

BALCONY = 122.22 SQ.FT.

TOTAL = 690.96 SQ.FT.

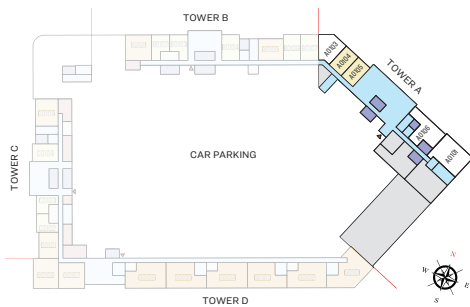

LEVEL 01(PODIUM 01)

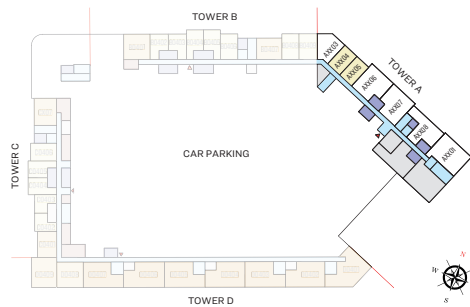

LEVEL 02-04

UNIT

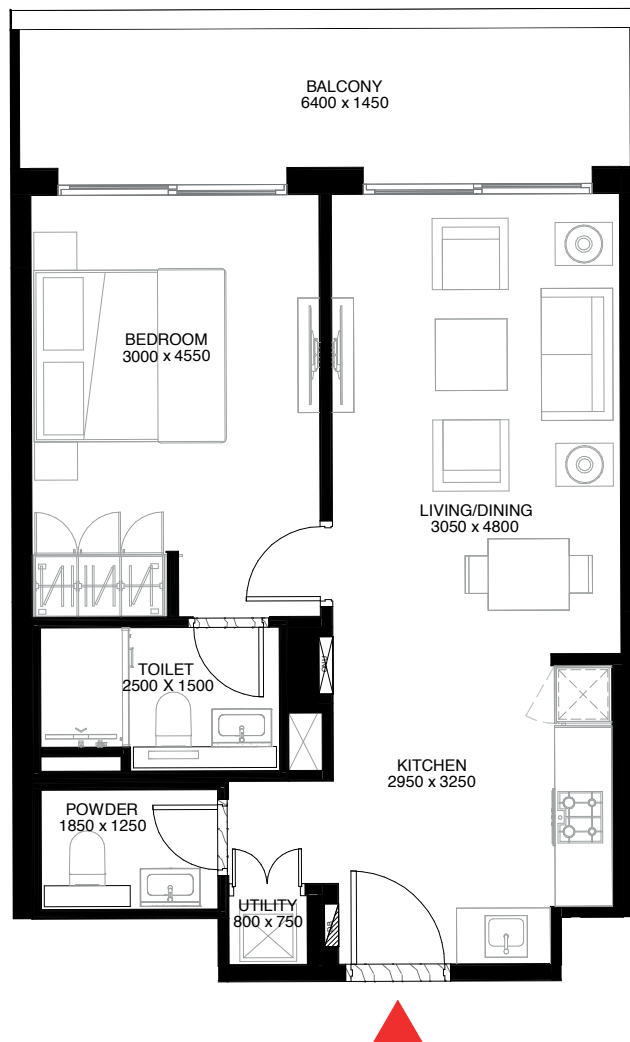

List of unit numbers with this unit plan:

VIEWS

Sports Court
A0104, A0105

Downtown, Sports Court
A0204, A0205, A0304, A0305, A0404, A0405

* These apartments have mirrored units plans of the above

1 BEDROOM APARTMENT

TYPE C (with powder room + balcony)

TOTAL SALEABLE AREA

SUITE = 634.75 SQ.FT.

BALCONY = 48.76 SQ.FT.

TOTAL = 683.51 SQ.FT.

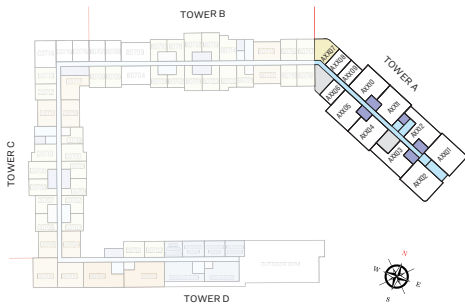

LEVEL 07-16

UNIT

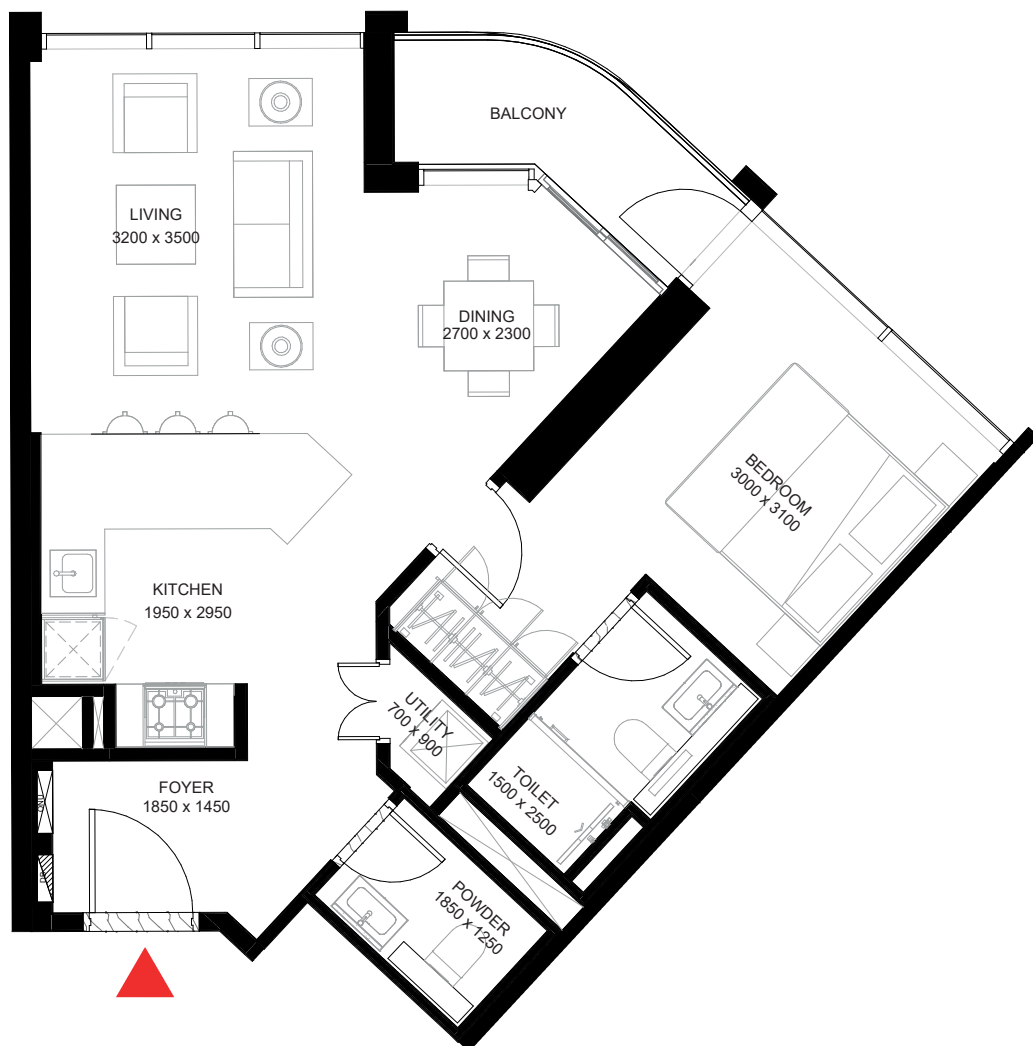

List of unit numbers with this unit plan:

VIEWS

Downtown, Sports Court, Ras Al Khor

A0707, A0807, A0907, A1007, A1107, A1207, A1307, A1407, A1507, A1607

* These apartments have mirrored units plans of the above

1 BEDROOM APARTMENT

TYPE C1 (with powder room + balcony)

TOTAL SALEABLE AREA

SUITE = 673.58 SQ.FT.
 BALCONY = 215.86 SQ.FT.
 TOTAL = 889.44 SQ.FT.

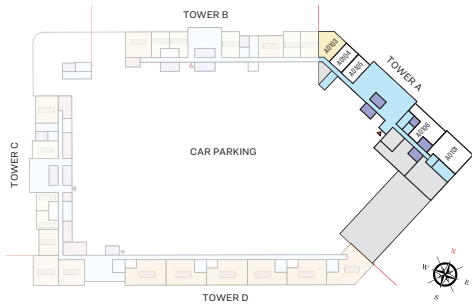

LEVEL 01

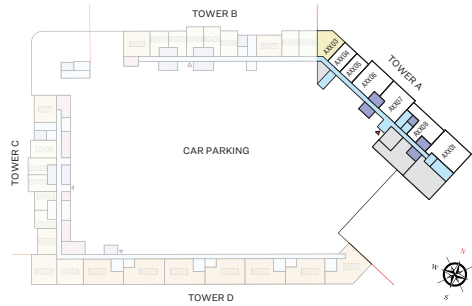

LEVEL 02-04

UNIT

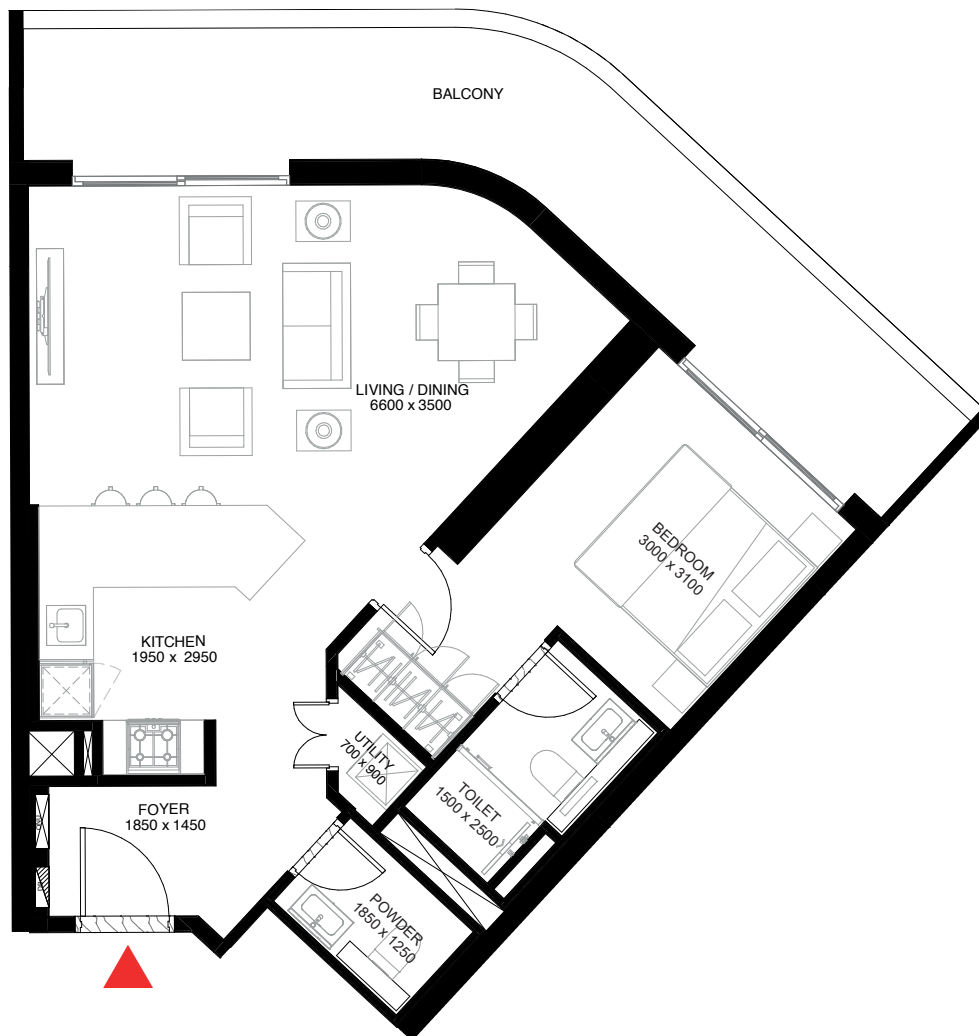

List of unit numbers with this unit plan:

VIEWS

Sports Court
 A0103

Downtown, Sports Court
 A0203, A0303, A0403

* These apartments have mirrored units plans of the above

2 BEDROOM APARTMENT

TYPE C (with maid room + balcony)

TOTAL SALEABLE AREA

SUITE = 1209.86 SQ.FT.

BALCONY = 60.82 SQ.FT.

TOTAL = 1270.68 SQ.FT.

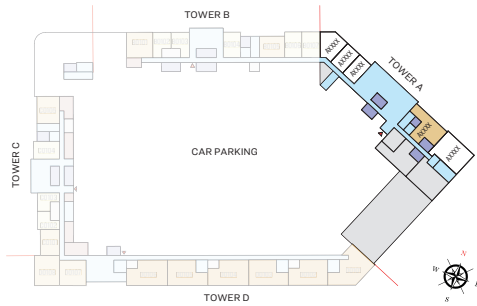

LEVEL 01-05

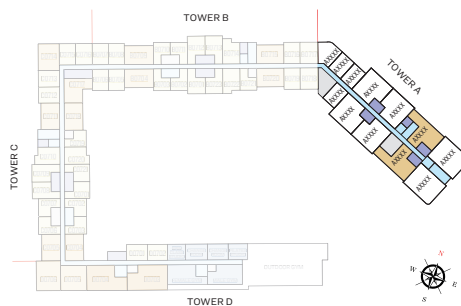

LEVEL 07-32

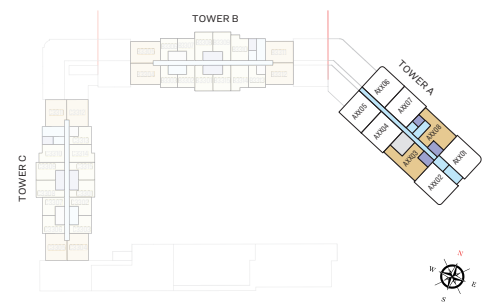

LEVEL 33-46

UNIT

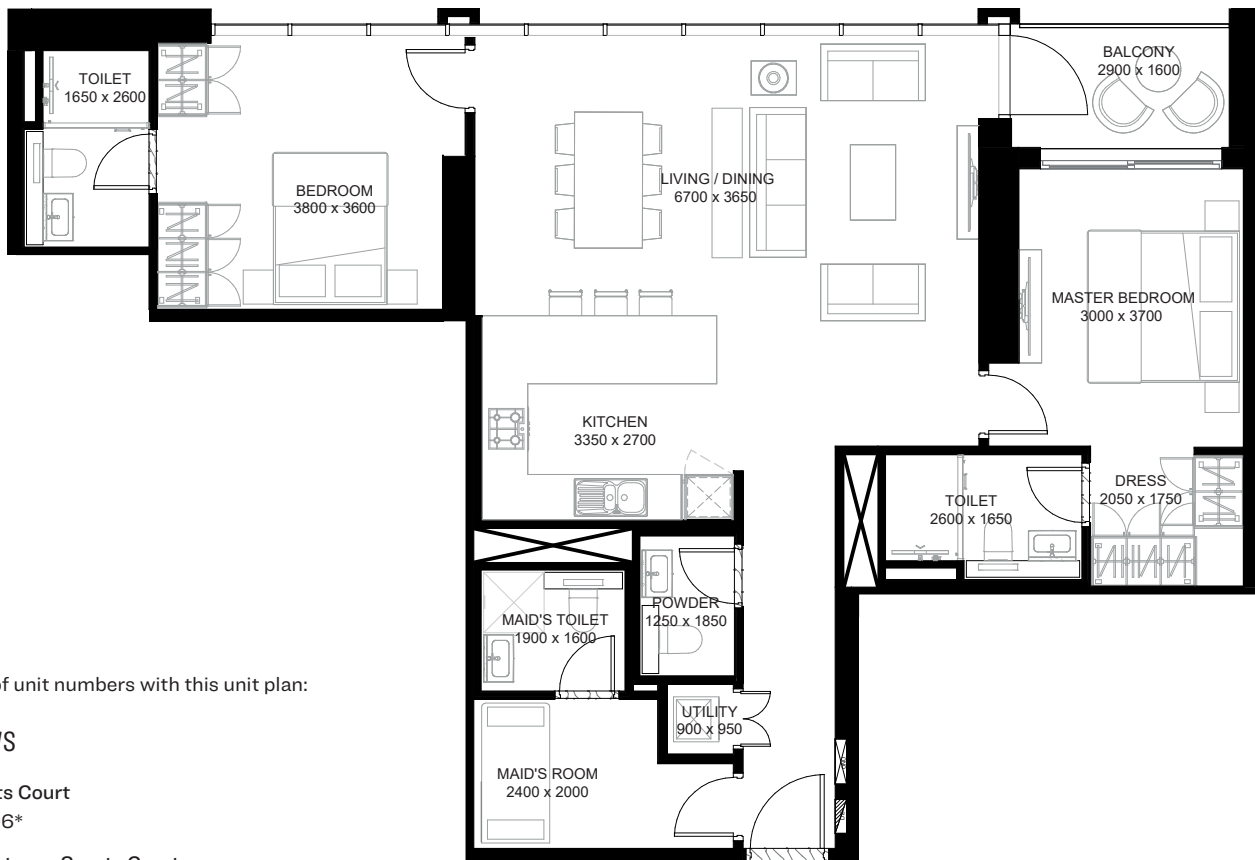

List of unit numbers with this unit plan:

VIEWS

Sports Court
A0106*

Downtown, Sports Court
A0208*, A0308*, A0408*, A0505*

Downtown, Sports Court, Ras Al Khor
A0712*, A0812*, A0912*, A1012*, A1112*, A1212*, A1312*, A1412*, A1512*, A1612*, A1709*, A1809*, A1909*, A2009*, A2109*, A2209, A2309*, A2409*, A2508*, A2604*, A2704*, A3106*, A3206*, A3308*, A3408*, A3508*, A3608*, A3708*, A3808*, A3908*, A4008*, A4108*, A4208*, A4308*, A4408*, A4508*, A4608*

Amenities, Waterfront

A0703, A0803, A0903, A1003, A1103, A1203, A1303, A1403, A1503, A1603, A1703, A1803, A1903, A2003, A2103, A2203, A2303, A2403, A2503, A2603, A2703, A3101, A3201, A3303, A3403, A3503, A3603, A3703, A3803, A3903, A4003, A4103

Amenities, Waterfront, Downtown

A4203, A4303, A4403, A4503, A4603

* These apartments have mirrored units plans of the above

2 BEDROOM APARTMENT

TYPE D (with maid room + balcony)

TOTAL SALEABLE AREA

SUITE = 1157.34 SQ.FT.

BALCONY = 114.85 SQ.FT.

TOTAL = 1272.19 SQ.FT.

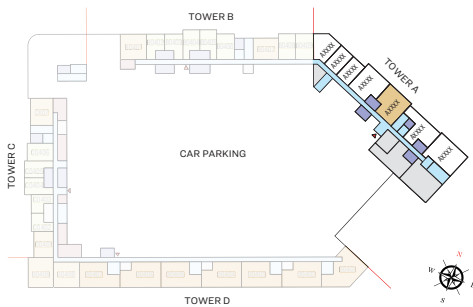

LEVEL 02-05

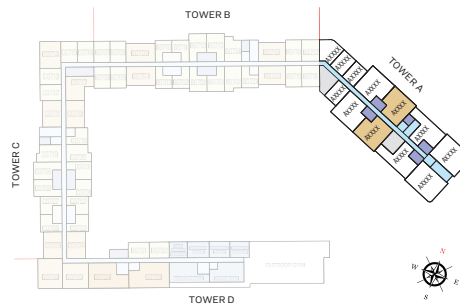

LEVEL 07-25

UNIT



List of unit numbers with this unit plan:

VIEWS

Amentites

A0704, A0804, A0904

Amenities, Waterfront

A1004, A1104, A1204, A1304, A1404, A1504, A1604, A1704, A1804, A1904, A2004, A2104, A2204, A2304, A2404, A2504

Downtown, Sports Court

A0207*, A0307*, A0407*, A0504*

Downtown, BK, Sports Court, Ras Al Khor

A0711*, A0811*, A0911*, A1011*, A1111*, A1211*, A1311*, A1411*, A1511*, A1611*, A1708*, A1808*, A1908*, A2008*, A2108*, A2208*, A2308*, A2408*, A2507*

* These apartments have mirrored units plans of the above

2 BEDROOM APARTMENT

TYPE E (with maid room + balcony)

TOTAL SALEABLE AREA

SUITE = 1170.36 SQ.FT.

BALCONY = 118.30 SQ.FT.

TOTAL = 1288.66 SQ.FT.

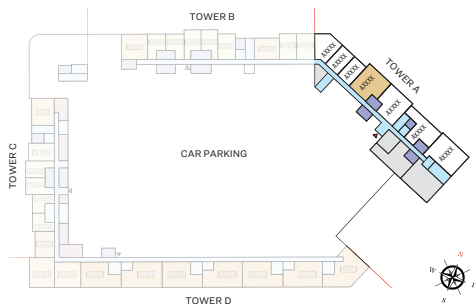

LEVEL 02-05

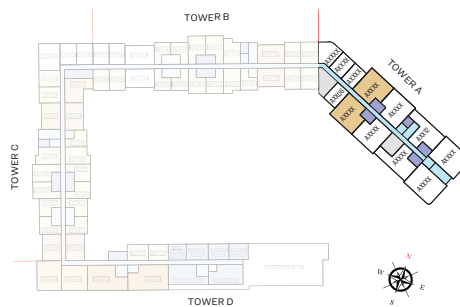

LEVEL 07-25

UNIT

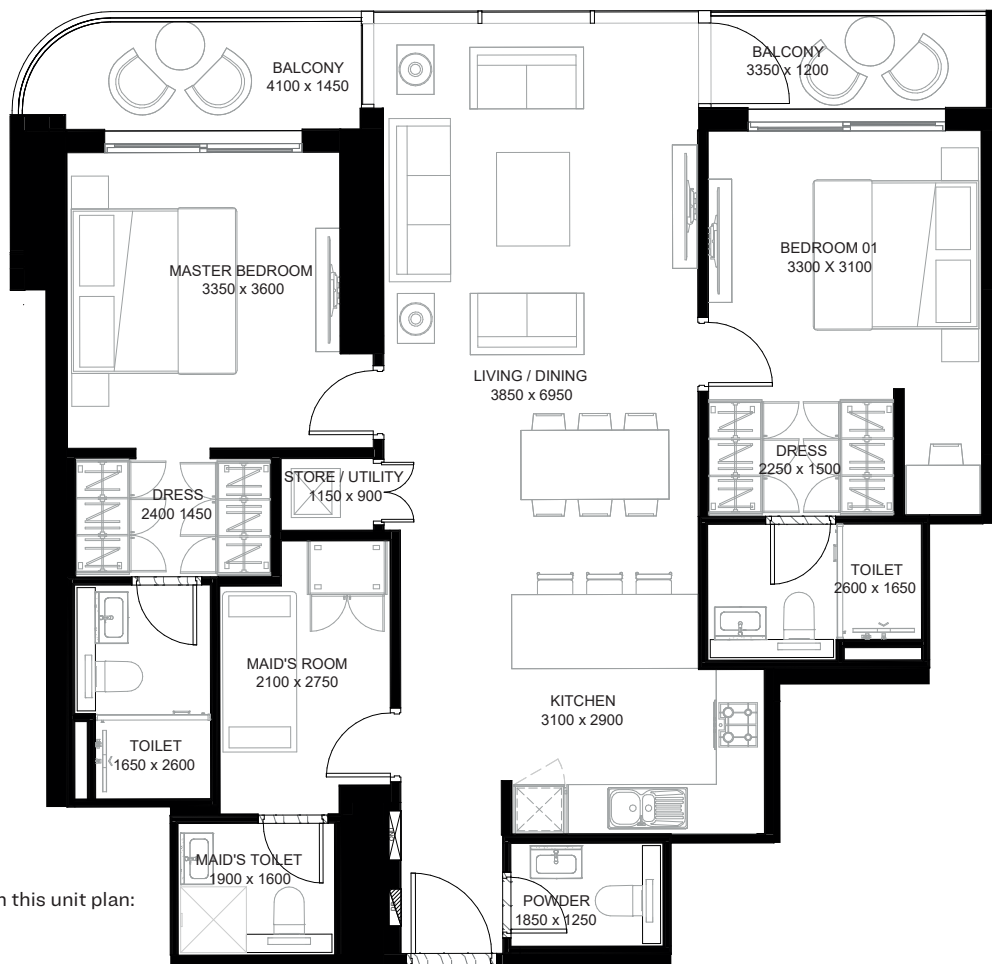

List of unit numbers with this unit plan:

VIEWS

Amenities

A0705, A0805, A0905

Amenities, Waterfront

A1005, A1105, A1205, A1305, A1405, A1505, A1605, A1705, A1805, A1905, A2005, A2105, A2205, A2305, A2405, A2505

Downtown, Sports Court

A0206*, A0306*, A0406*, A0503*

Downtown, Sports Court, Ras Al Khor

A0710*, A0810*, A0910*, A1010*, A1110*, A1210*, A1310*, A1410*, A1510*, A1610*, A1707*, A1807*, A1907*, A2007*, A2107*, A2207*, A2307*, A2407*, A2506*

* These apartments have mirrored units plans of the above

2 BEDROOM APARTMENT

TYPE F (with maid room + balcony)

TOTAL SALEABLE AREA

SUITE = 1279.51 SQ.FT.

BALCONY = 114.74 SQ.FT.

TOTAL = 1394.25 SQ.FT.

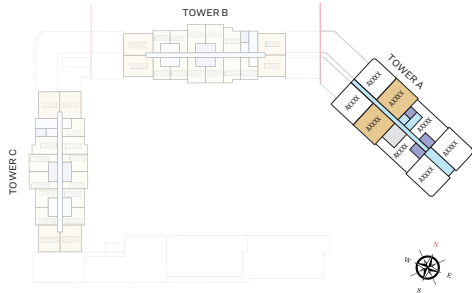

LEVEL 29-46

UNIT

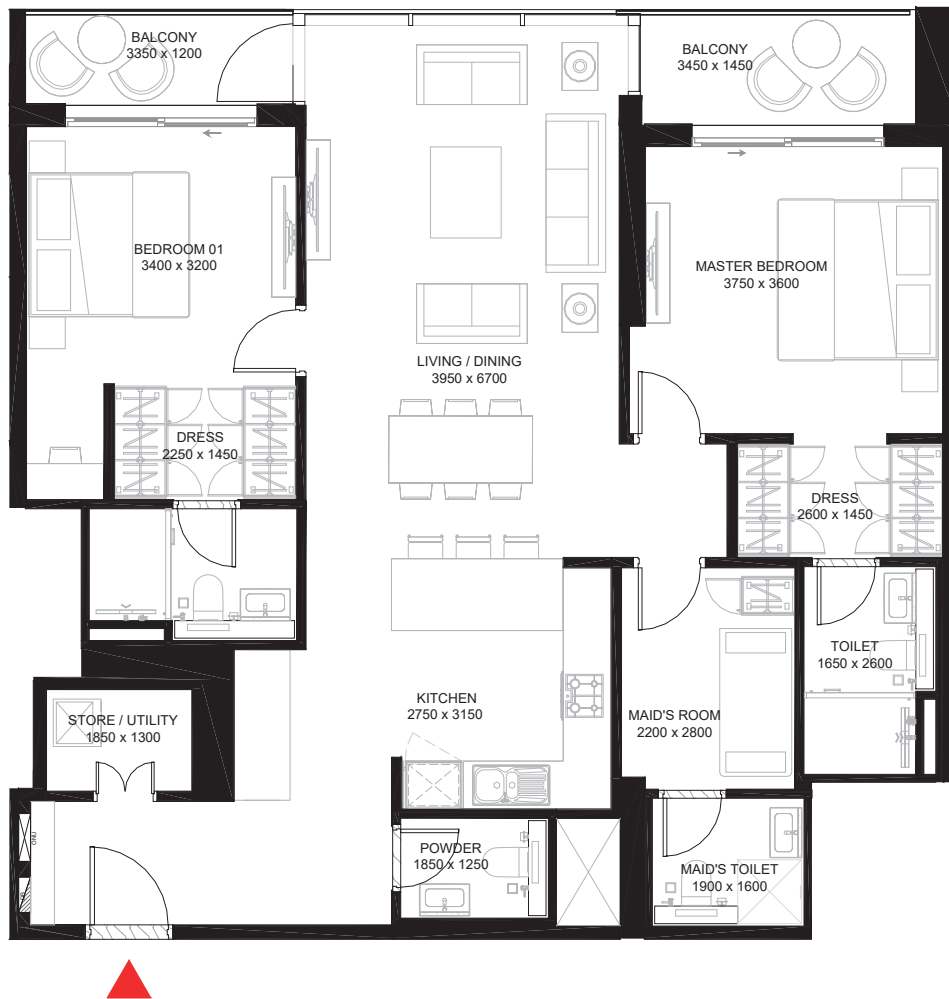

List of unit numbers with this unit plan:

VIEWS

Amenities, Waterfront

A2901, A3001, A3102, A3202, A3304, A3404, A3504, A3604, A3704, A3804, A3904, A4004, A4104

Amenities, Waterfront, Downtown

A4204, A4304, A4404, A4504, A4604

Downtown, Sports Court, Ras Al Khor

A2904*, A3004*, A3105*, A3205*, A3307*, A3407*, A3507*, A3607*, A3707*, A3807*, A3907*, A4007*, A4107*, A4207*, A4307*, A4407*, A4507*, A4607*

* These apartments have mirrored units plans of the above

2 BEDROOM APARTMENT

TYPE G (with maid room + balcony)

TOTAL SALEABLE AREA

SUITE = 1270.25 SQ.FT.

BALCONY = 116.57 SQ.FT.

TOTAL = 1386.82 SQ.FT.

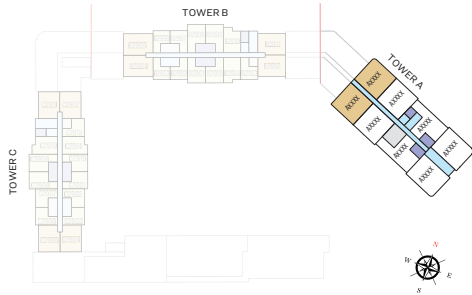

LEVEL 29-46

UNIT



List of unit numbers with this unit plan:

VIEWS

Downtown, Sports Court, Ras Al Khor

A2903*, A3003*, A3104*, A3204*, A3306*, A3406*, A3506*, A3606*, A3706*, A3806*, A3906*, A4006*, A4106*, A4206*, A4306*, A4406*, A4506*, A4606*

Amenities, Waterfront, Downtown

A2902, A3002, A3103, A3203, A3305, A3405, A3505, A3605, A3705, A3805, A3905, A4005, A4105, A4205, A4305, A4405, A4505, A4605

* These apartments have mirrored units plans of the above

3 BEDROOM APARTMENT

TYPE B (with maid room + balcony)

TOTAL SALEABLE AREA

SUITE = 1497.15 SQ.FT.

BALCONY = 68.24 SQ.FT.

TOTAL = 1565.40 SQ.FT.

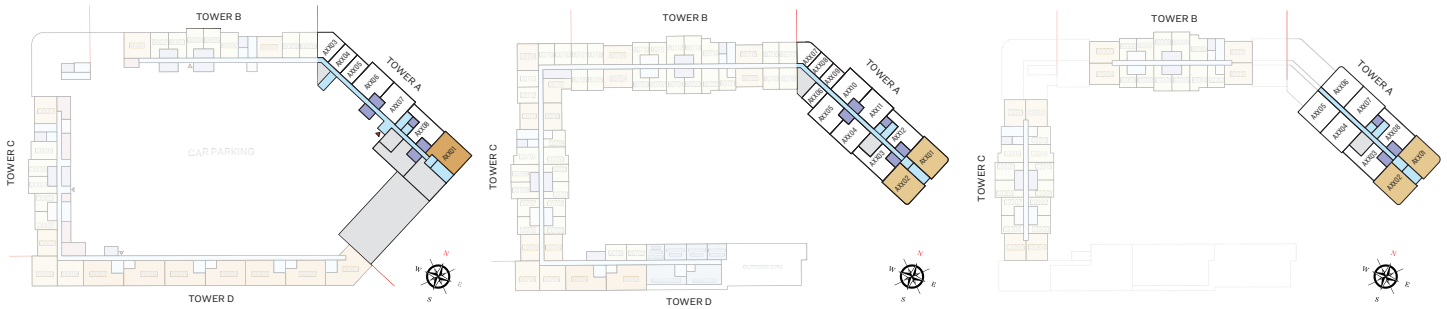

LEVEL 01-05

LEVEL 07-28

LEVEL 33-46

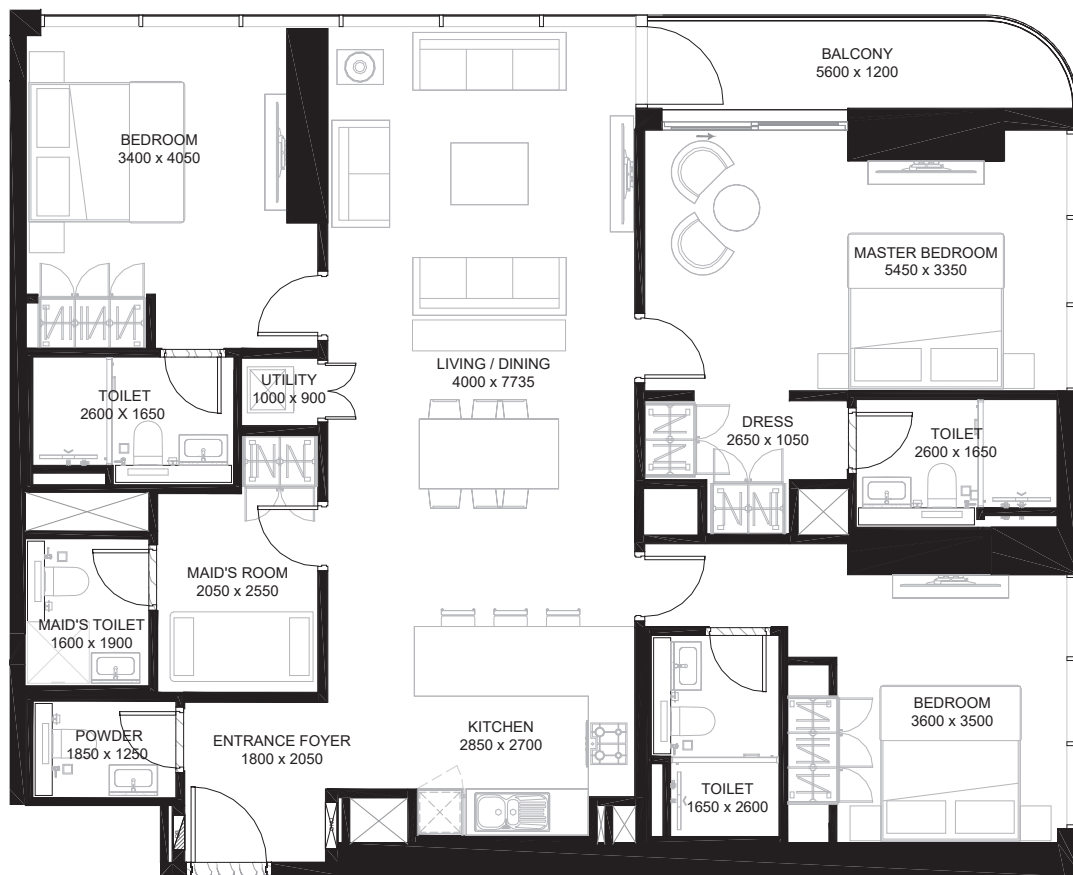

List of unit numbers with this unit plan:

VIEWS

Amenities, Waterfront

A0702*, A0802*, A0902*, A1002*, A1102*, A1202*, A1302*, A1402*, A1502*, A1602*, A1702*, A1802*, A1902*, A2002*, A2102*, A2202*, A2302*, A2402*, A2502*, A2602*, A2702*, A2802*, A3302*, A3402*, A3502*, A3602*, A3702*, A3802*, A3902*, A4002*, A4102*

Amenities, Waterfront, Downtown

A4202*, A4302*, A4402*, A4502*, A4602*

Sports Court

A0101

Downtown, Sports Court

A0201, A0301, A0401, A0501

Downtown, Sports Court, Ras Al Khor

A0701, A0801, A0901, A1001, A1101, A1201, A1301, A1401, A1501, A1601, A1701, A1801, A1901, A2001, A2101, A2201, A2301, A2401, A2501, A2601, A2701, A2801, A3301, A3401, A3501, A3601, A3701, A3801, A3901, A4001, A4101, A4201, A4301, A4401, A4501, A4601

* These apartments have mirrored units plans of the above

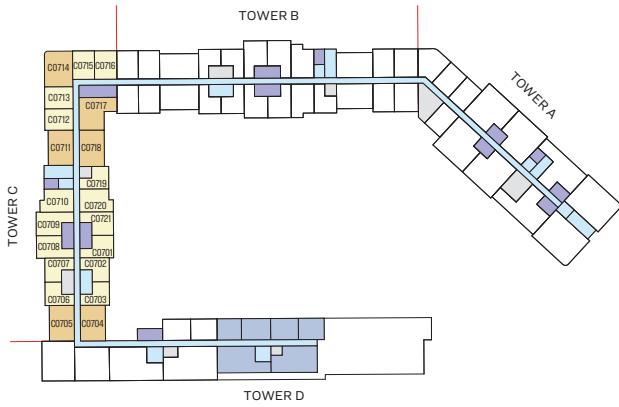
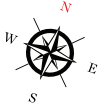

LEVEL-07

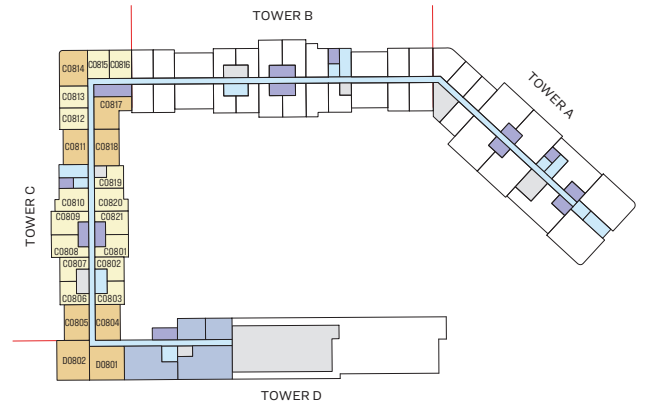

LEVEL-08

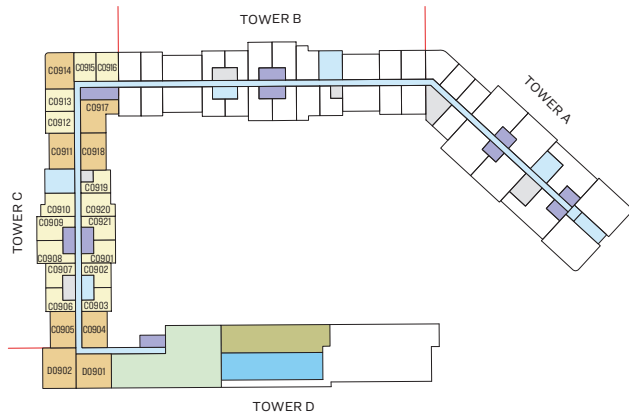

LEVEL-09

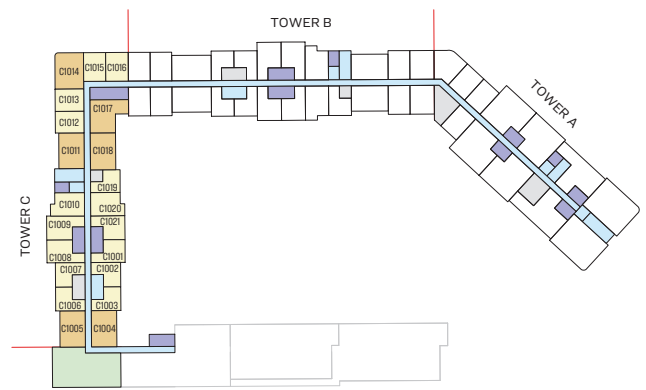

LEVEL 10

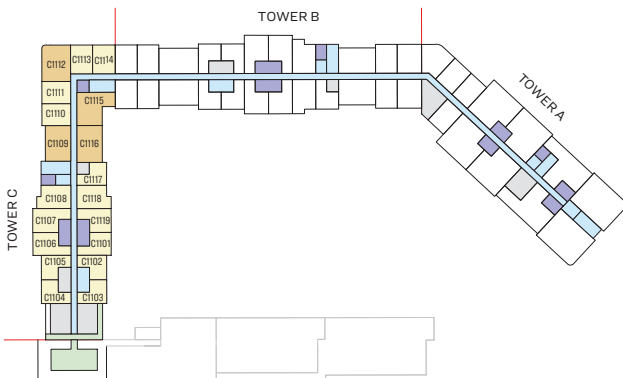

LEVEL 11

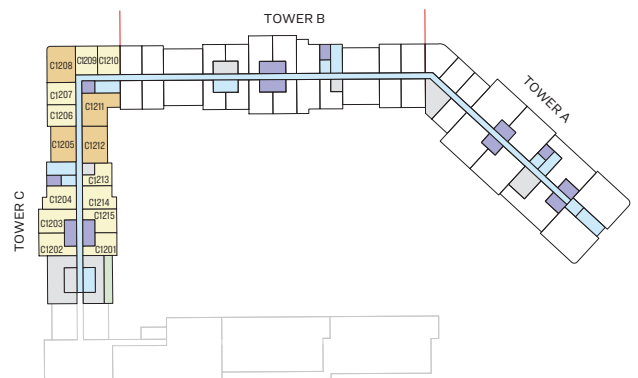

LEVEL 12

- | | | |
|---|---|--|
| 1 BED UNIT | SERVICES | SWIMMING POOL |
| 2 BED UNIT | LIFT | SWIMMING POOL DECK |
| 3 BED UNIT | AMENITIES | |
| LOBBIES, CORRIDORS & STAIRS | LANDSCAPE | |

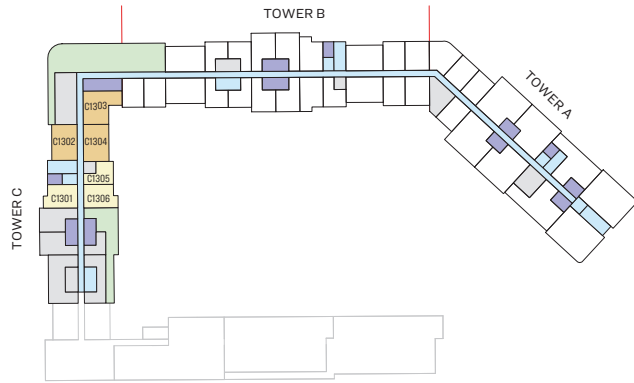
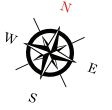

LEVEL 13

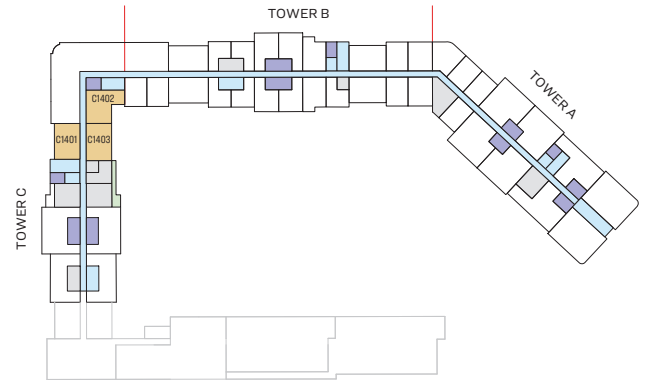

LEVEL 14

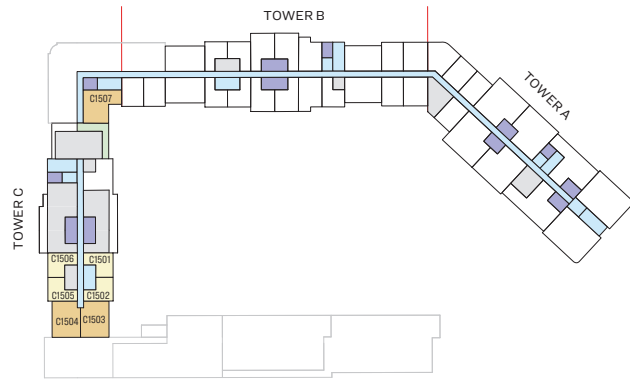

LEVEL 15

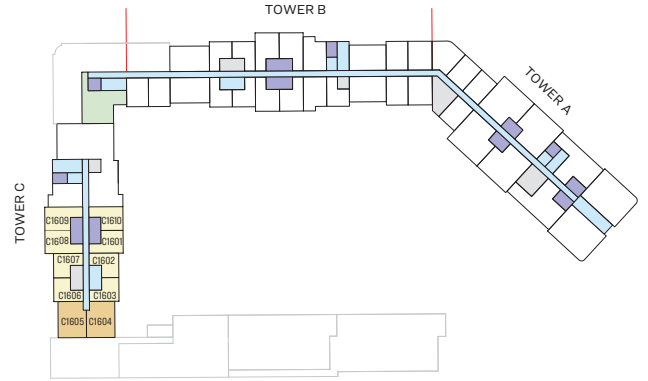

LEVEL 16

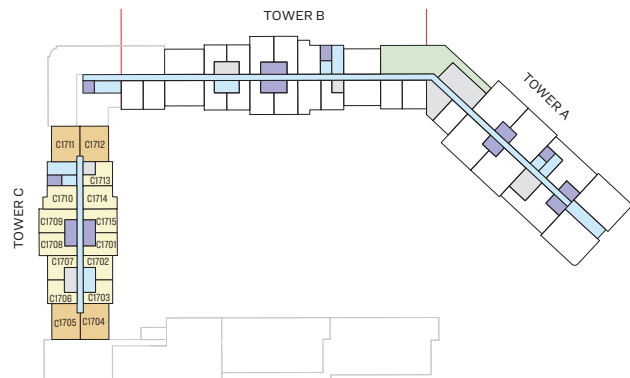

LEVEL 17

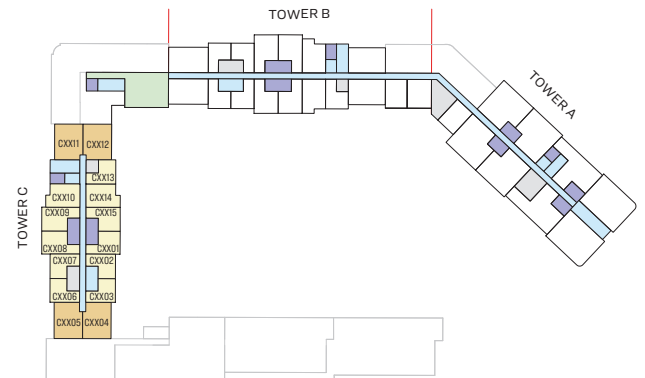

LEVEL 18 - LEVEL 33

- | | |
|--|--|
| 1 BED UNIT | SERVICES |
| 2 BED UNIT | LIFT |
| 3 BED UNIT | AMENITIES |
| LOBBIES, CORRIDORS & STAIRS | LANDSCAPE |

1 BEDROOM APARTMENT

TYPE B (with balcony)

TOTAL SALEABLE AREA

SIZE RANGE = 509.46 SQ.FT. - 518.07 SQ.FT.

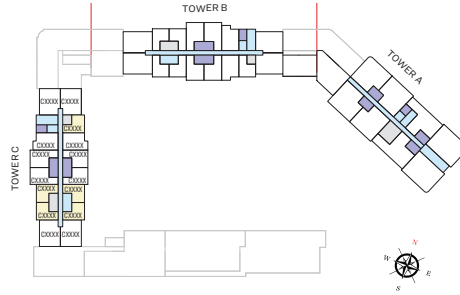
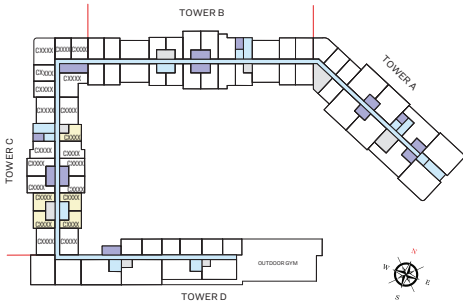

UNIT

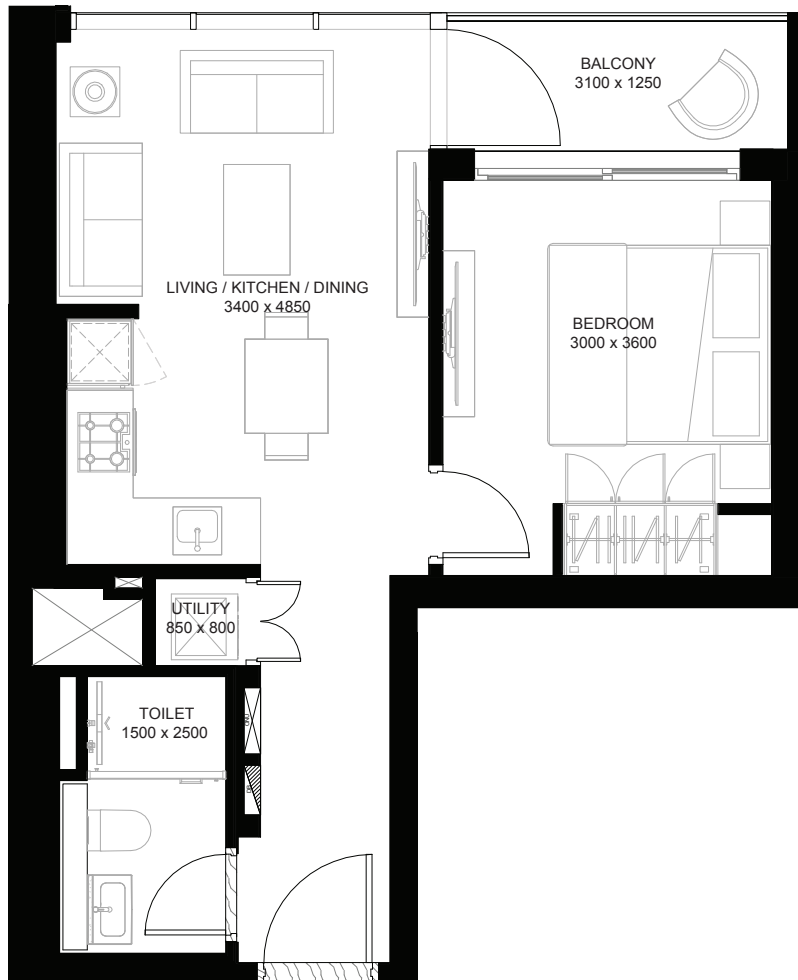

List of unit numbers with this unit plan:

VIEWS

Amenities

C0702, C0703*, C0719*, C0802, C0803*, C0819*, C0902, C0903*, C0919*, C1002, C1003*, C1019*, C1102, C1103*, C1117*, C1213*, C1305*

Hartland, Waterfront

C0706*, C0707*, C0806*, C0807*, C0906*, C0907*, C1006*, C1007*, C1104*, C1105*, C1505*, C1506*, C1606*, C1607*, C1706*, C1707*, C1806*, C1807*, C1906*, C1907*, C2006*, C2007*, C2106*, C2107*, C2206*, C2207*, C2306*, C2307*, C2406*, C2407*, C2506*, C2507*

Downtown, BK, Hartland, Waterfront

C2606*, C2607*, C2706*, C2707*, C2806*, C2807*, C2906*, C2907*, C3006*, C3007*, C3106*, C3107*, C3206*, C3207*, C3306*, C3307*

Amenities, Waterfront

C1501, C1502*, C1602, C1603*, C1702, C1703*, C1713*, C1802, C1803*, C1813*, C1902, C1903*, C1913*, C2002, C2003*, C2013*, C2102, C2103*, C2113*, C2202, C2203*, C2213*, C2302, C2303*, C2313*, C2402, C2403*, C2413*, C2502, C2503*, C2513*, C2602, C2603*, C2613*, C2702, C2703*, C2713*, C2802, C2803*, C2813*, C2902, C2903*, C2913*, C3002, C3003*, C3013*, C3102, C3103*, C3113*, C3202, C3203*, C3213*, C3302, C3303*, C3313*

* These apartments have mirrored units plans of the above

1 BEDROOM APARTMENT

TYPE A (with powder room + balcony)

TOTAL SALEABLE AREA

SIZE RANGE = 565.00 SQ.FT. - 572.53 SQ.FT.

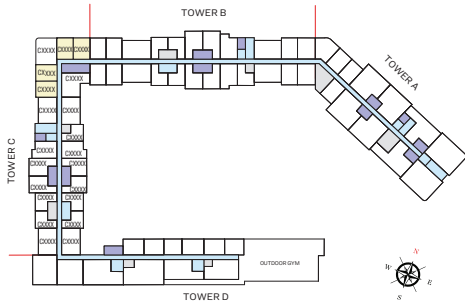

UNIT

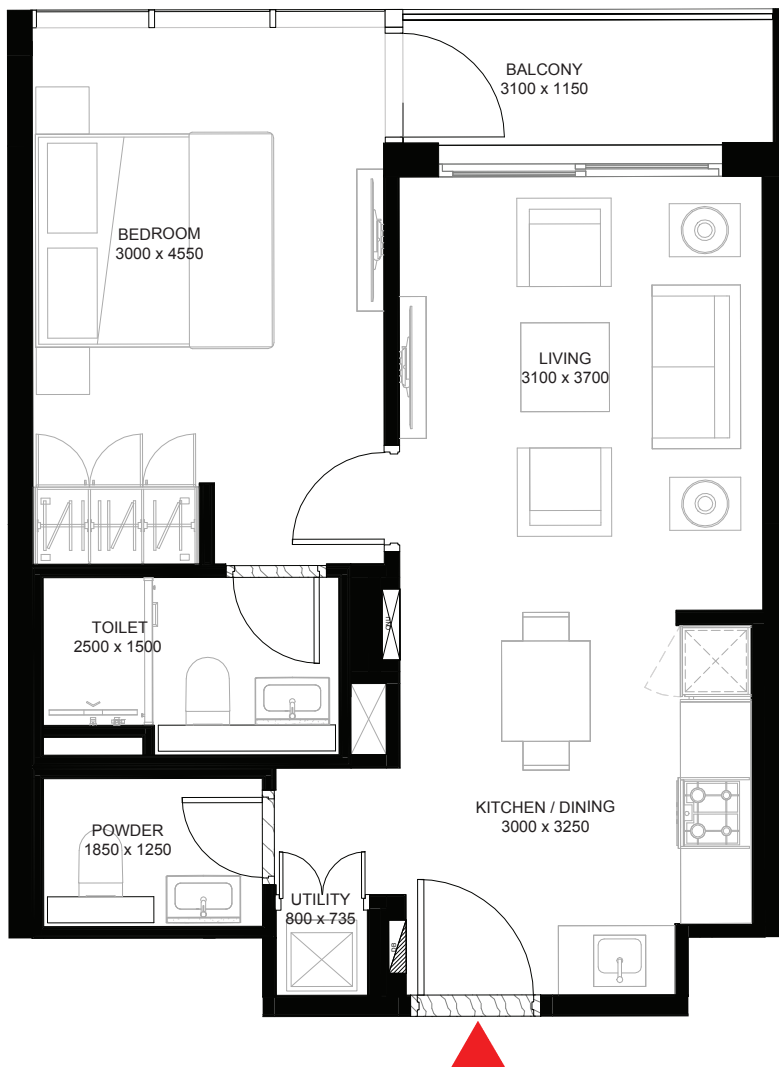

List of unit numbers with this unit plan:

VIEWS

Hartland

C0712*, C0713*, C0715, C0716*, C0812*, C0813*, C0815, C0816*, C0912*, C0913*, C0915, C0916*, C1012*, C1013*, C1015, C1016*, C1110*, C1111*, C1113, C1114*, C1206*, C1207*, C1209, C1210*

* These apartments have mirrored units plans of the above

1 BEDROOM APARTMENT

TYPE B (with powder room + balcony)

TOTAL SALEABLE AREA

SIZE RANGE = 586.09 SQ.FT. - 608.91 SQ.FT.

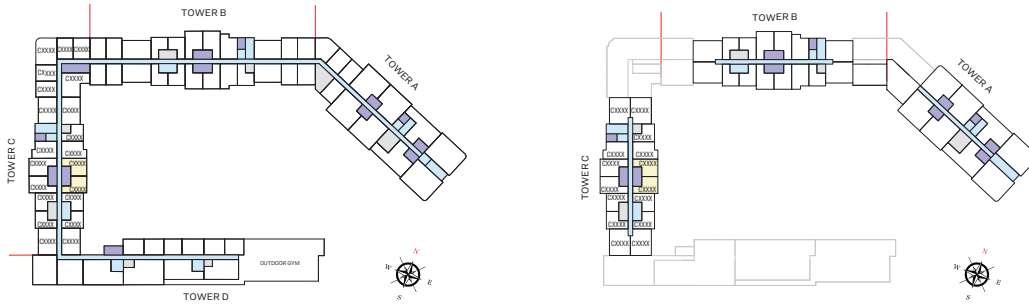

UNIT



List of unit numbers with this unit plan:

VIEWS

Amenities

C0701, C0721*, C0801, C0821*, C0901, C0921*, C1001, C1021*, C1101, C1119*, C1201, C1215*

Amenities, Waterfront

C1601, C1610*, C1701, C1715*, C1801, C1815*, C1901, C1915*, C2001, C2015*, C2101, C2115*, C2201, C2215*, C2301, C2315*, C2401, C2415*, C2501, C2515*, C2601, C2615*, C2701, C2715*, C2801, C2815*, C2901, C2915*, C3001, C3015*, C3101, C3115*, C3201, C3215*, C3301, C3315*

* These apartments have mirrored units plans of the above

1 BEDROOM APARTMENT

TYPE A (with study/store + balcony)

TOTAL SALEABLE AREA

SIZE RANGE = 673.61 SQ.FT. - 685.55 SQ.FT.

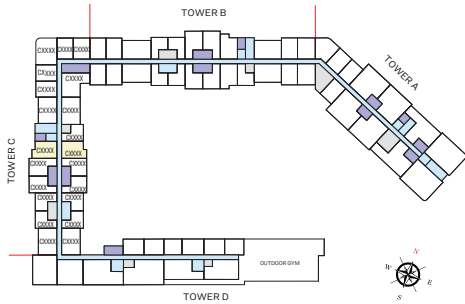

UNIT

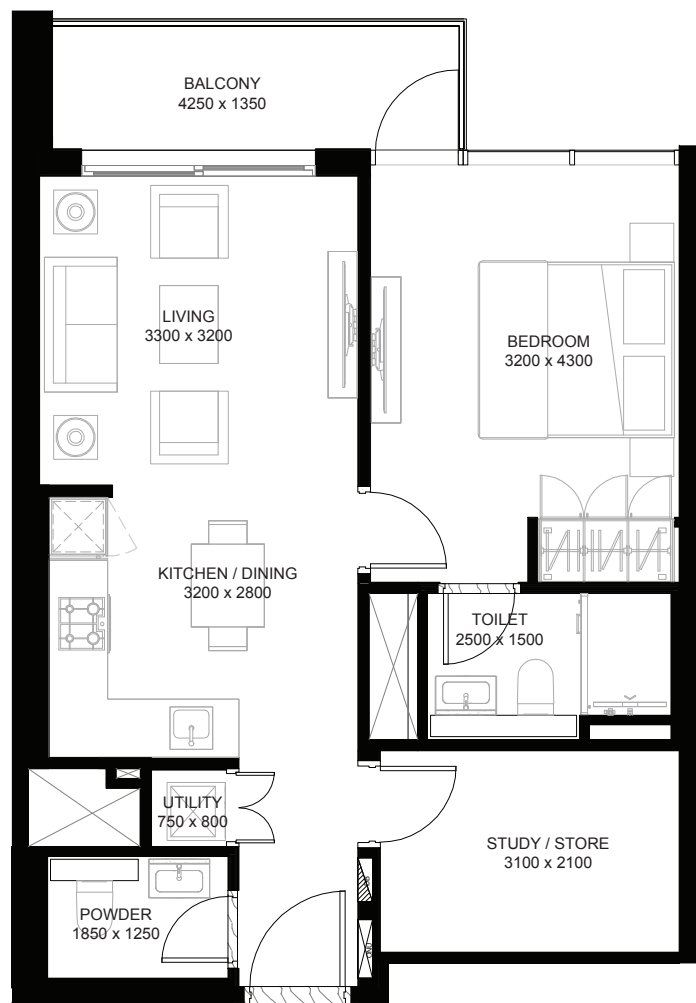

List of unit numbers with this unit plan:

VIEWS

Downtown, Hartland

C1710, C1810, C1910, C2010, C2110, C2210, C2310

Downtown, BK, Hartland

C2410, C2510, C2610, C2710, C2810, C2910, C3010, C3110, C3210, C3310

Amenities, Waterfront

C1714*, C1814*, C1914*, C2014*, C2114*, C2214*, C2314*, C2414*, C2514*, C2614*, C2714*, C2814*, C2914*, C3014*, C3114*, C3214*, C3314*

* These apartments have mirrored units plans of the above

1 BEDROOM APARTMENT

TYPE B (with study/store + balcony)

TOTAL SALEABLE AREA

SIZE RANGE = 677.70 SQ.FT. - 687.60 SQ.FT.

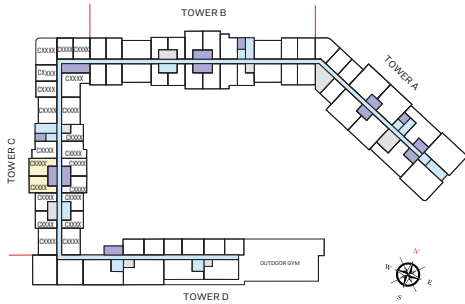

UNIT

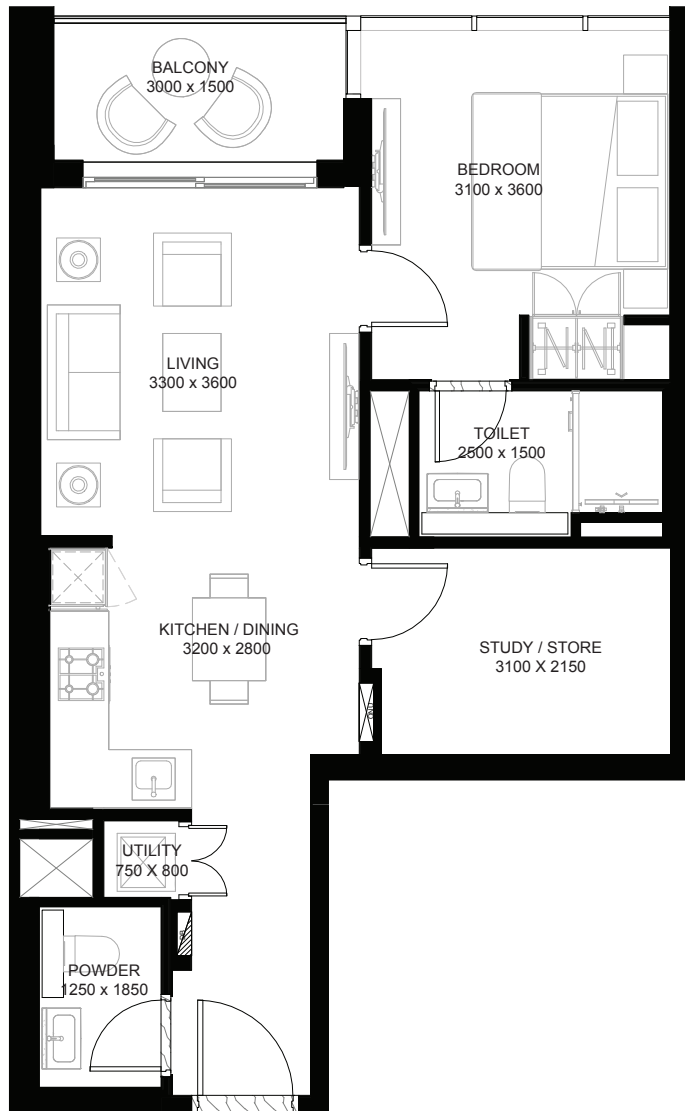

List of unit numbers with this unit plan:

VIEWS

Hartland, Waterfront

C0708, C0709*, C0808, C0809*, C0908, C0909*, C1008, C1009*, C1106, C1107*, C1202, C1203*

Downtown, Hartland, Waterfront

C1608, C1609*, C1708, C1709*, C1808, C1809*, C1908, C1909*, C2008, C2009*, C2108, C2109*, C2208, C2209*, C2308, C2309*

Downtown, BK, Hartland, Waterfront

C2408, C2409*, C2508, C2509*, C2608, C2609*, C2708, C2709*, C2808, C2809*, C2908, C2909*, C3008, C3009*, C3108, C3109*, C3208, C3209*, C3308, C3309*

* These apartments have mirrored units plans of the above

2 BEDROOM APARTMENT

TYPE A (with balcony)

TOTAL SALEABLE AREA

SIZE RANGE = 790.39 SQ.FT. - 806.86 SQ.FT.

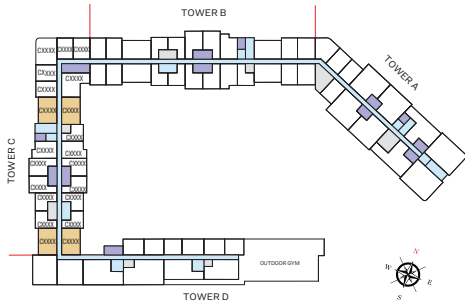

UNIT

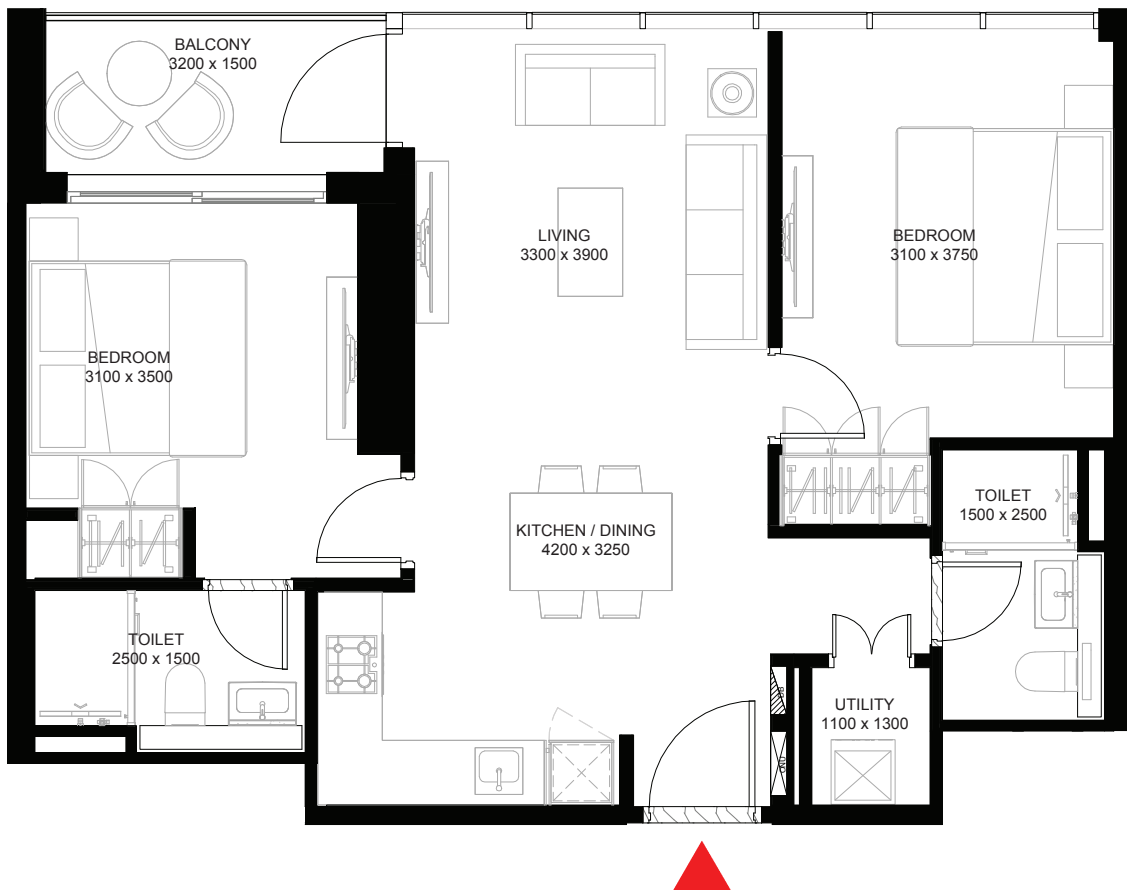

List of unit numbers with this unit plan:

VIEWS

Amenities

C0704, C0718*, C0804, C0818*, C0904, C0918*, C1004, C1018*, C1116*, C1212*, C1304*

Hartland

C0711*, C0811*, C0911*, C1011*, C1109*, C1205*, C1302*, C1401

Hartland, Waterfront

C0705*, C0805*, C0905*, C1005*

Amentites, Waterfront

C1403*

* These apartments have mirrored units plans of the above

2 BEDROOM APARTMENT

TYPE B (with balcony)

TOTAL SALEABLE AREA

SIZE = 896.96 SQ.FT.

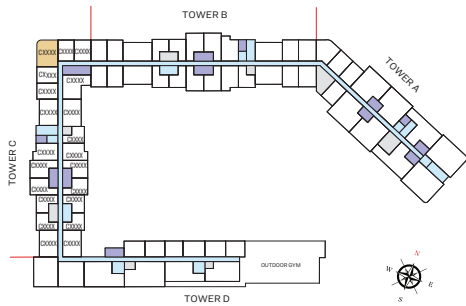

UNIT

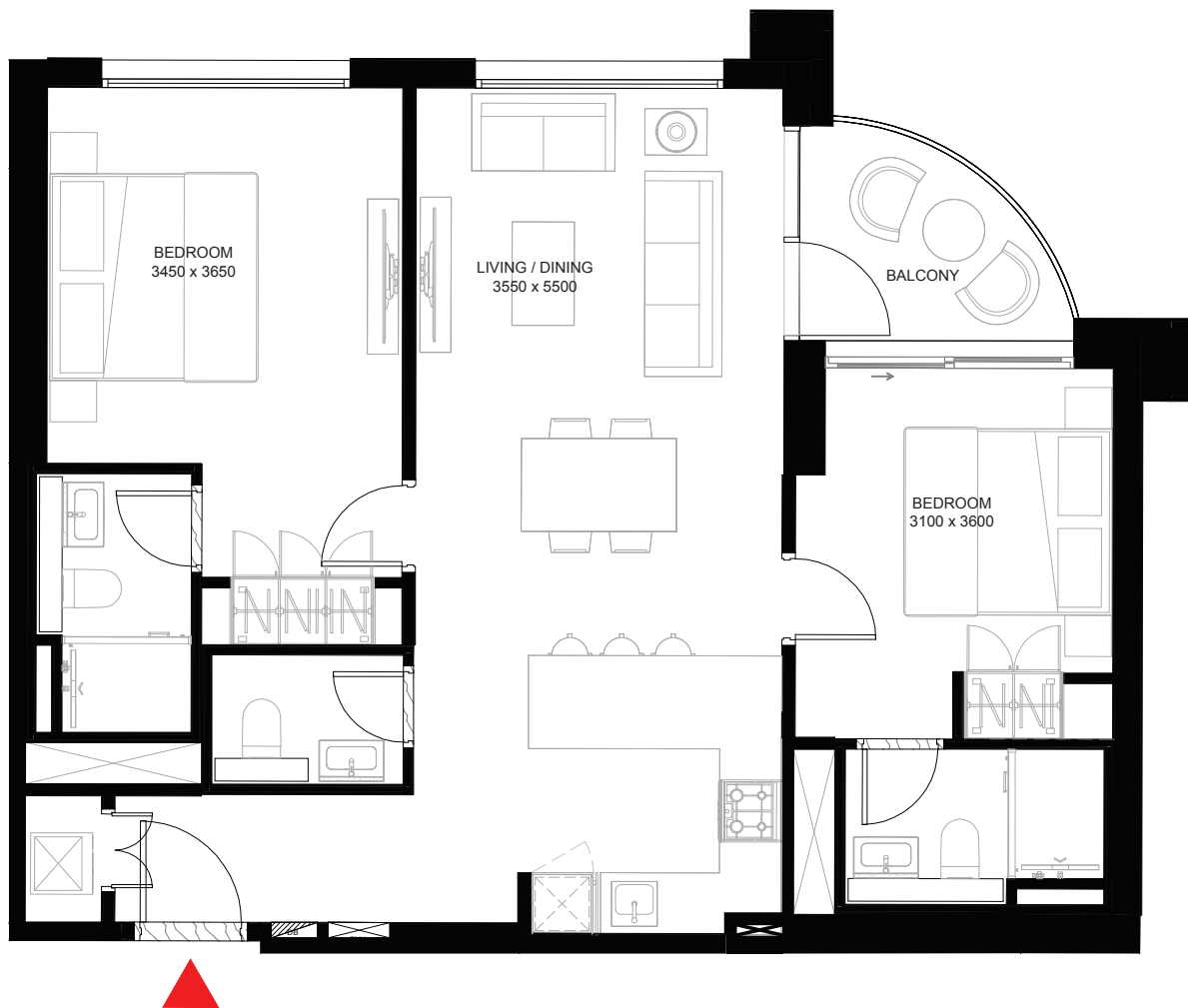

List of unit numbers with this unit plan:

VIEWS

Hartland

C0714, C0814, C0914, C1014, C1112, C1208

* These apartments have mirrored units plans of the above

2 BEDROOM APARTMENT

TYPE C (with balcony)

TOTAL SALEABLE AREA

SIZE RANGE = 913.53 SQ.FT. - 919.67 SQ.FT.

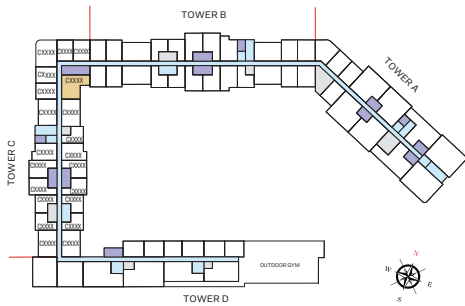

UNIT



List of unit numbers with this unit plan:

VIEWS

Amenities

C0717, C0817, C0917, C1017, C1115, C1211, C1303

Amentities, Waterfront

C1402, C1507

* These apartments have mirrored units plans of the above

2 BEDROOM APARTMENT

TYPE A (with study/store + balcony)

TOTAL SALEABLE AREA

SIZE RANGE = 1,047.97 SQ.FT. -1,058.09 SQ.FT.

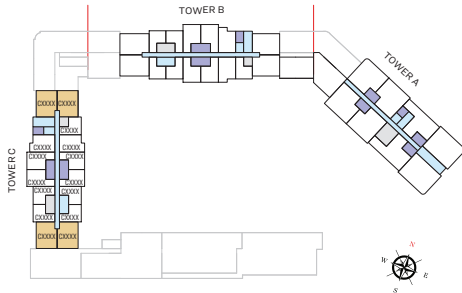

UNIT



List of unit numbers with this unit plan:

VIEWS

Downtown, BK, Hartland

C2411*, C2511*, C2611*, C2711*, C2811*, C2911*, C3011*, C3111*, C3211*, C3311*

Downtown, BK, Hartland, Amenities, Waterfront

C2412*, C2512*, C2612*, C2712*, C2812*, C2912*, C3012*, C3112*, C3212*, C3312*

Downtown, Hartland

C1711*, C1811*, C1911*, C2011*, C2111*, C2211*, C2311*

Hartland, Waterfront

C1504*, C1605*, C1705*, C1805*, C1905*, C2005*, C2105*, C2205*, C2305*, C2405*, C2505*

Downtown, BK, Hartland, Waterfront

C2605*, C2705*, C2805*, C2905*, C3005*, C3105*, C3205*, C3305*

Downtown, Hartland, Amenities, Waterfront

C1812*, C1912*, C2012*, C2112*, C2212*, C2312*

Amentites, Waterfront

C1503, C1604, C1704, C1712*, C1804, C1904, C2004, C2104, C2204, C2304, C2404, C2504, C2604, C2704, C2804, C2904, C3004, C3104, C3204, C3304

* These apartments have mirrored units plans of the above

FLOOR PLAN LAYOUT

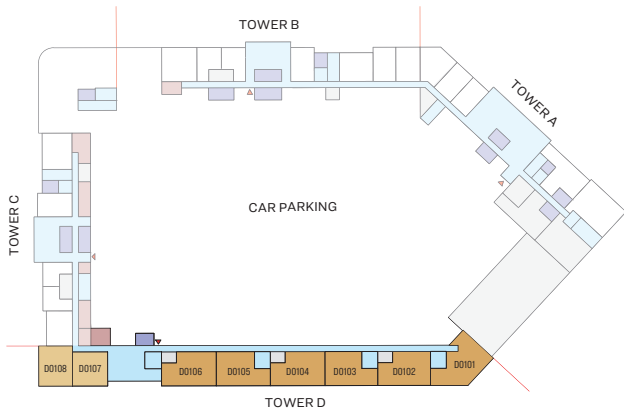
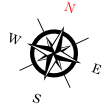

LEVEL-01(PODIUM 01)

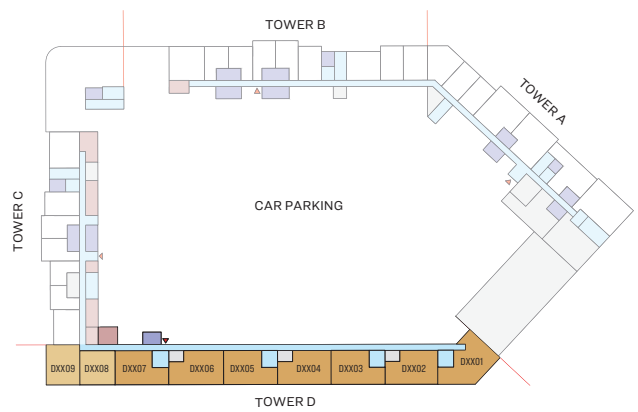

LEVEL-02, 03, 04 (PODIUM 02, 03, 04)

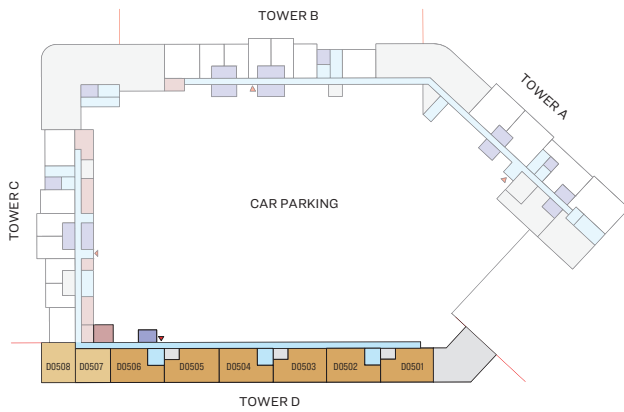

LEVEL-05(PODIUM 05)

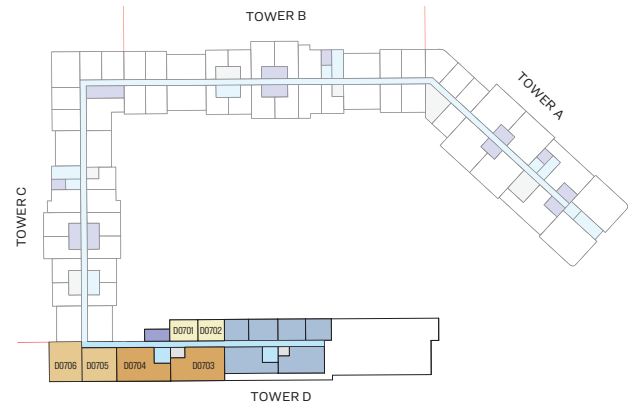

LEVEL-07

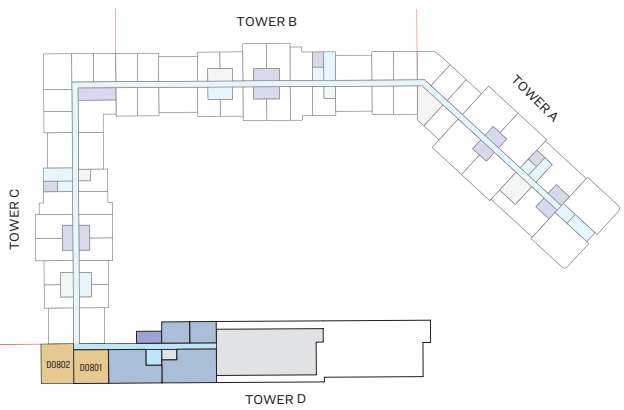

LEVEL-08

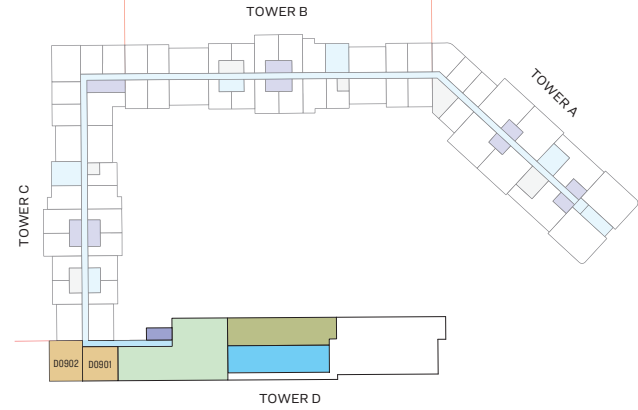

LEVEL-09

- | | | |
|---|---|--|
| 1 BED UNIT | SERVICES | SWIMMING POOL |
| 2 BED UNIT | LIFT | SWIMMING POOL DECK |
| 3 BED UNIT | AMENITIES | LANDSCAPE |
| LOBBIES, CORRIDORS & STAIRS | | |

1 BEDROOM APARTMENT

TYPE A (with balcony)

TOTAL SALEABLE AREA

SIZE = 515.05 SQ.FT.

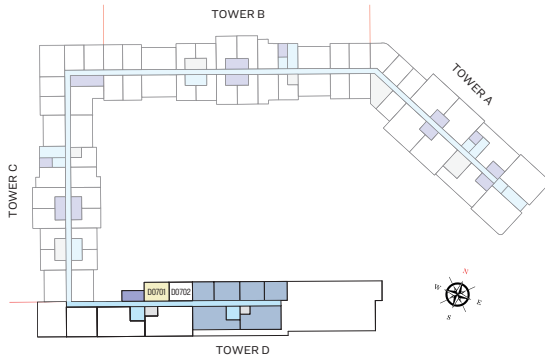

UNIT

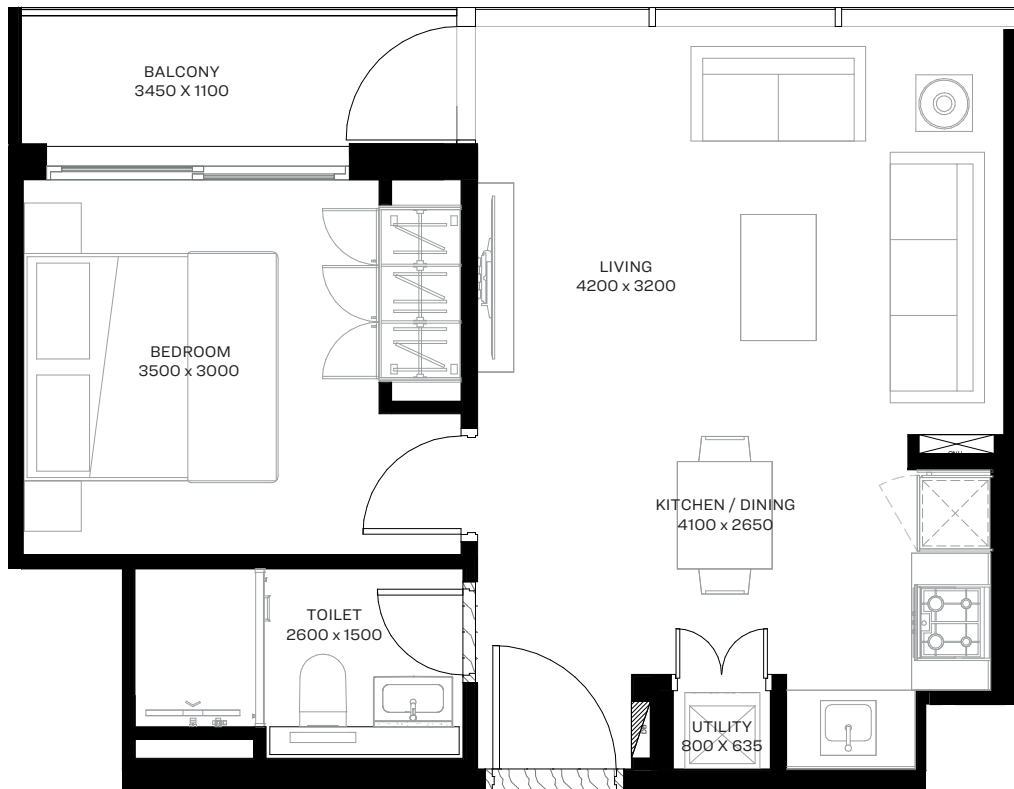

List of unit numbers with this unit plan:

VIEWS

Amenities
D0701



1 BEDROOM APARTMENT

TYPE A - Mirror Unit (with balcony)

TOTAL SALEABLE AREA

SIZE = 501.49 SQ.FT.

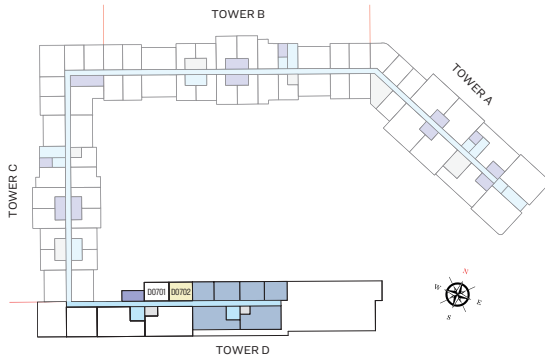

UNIT

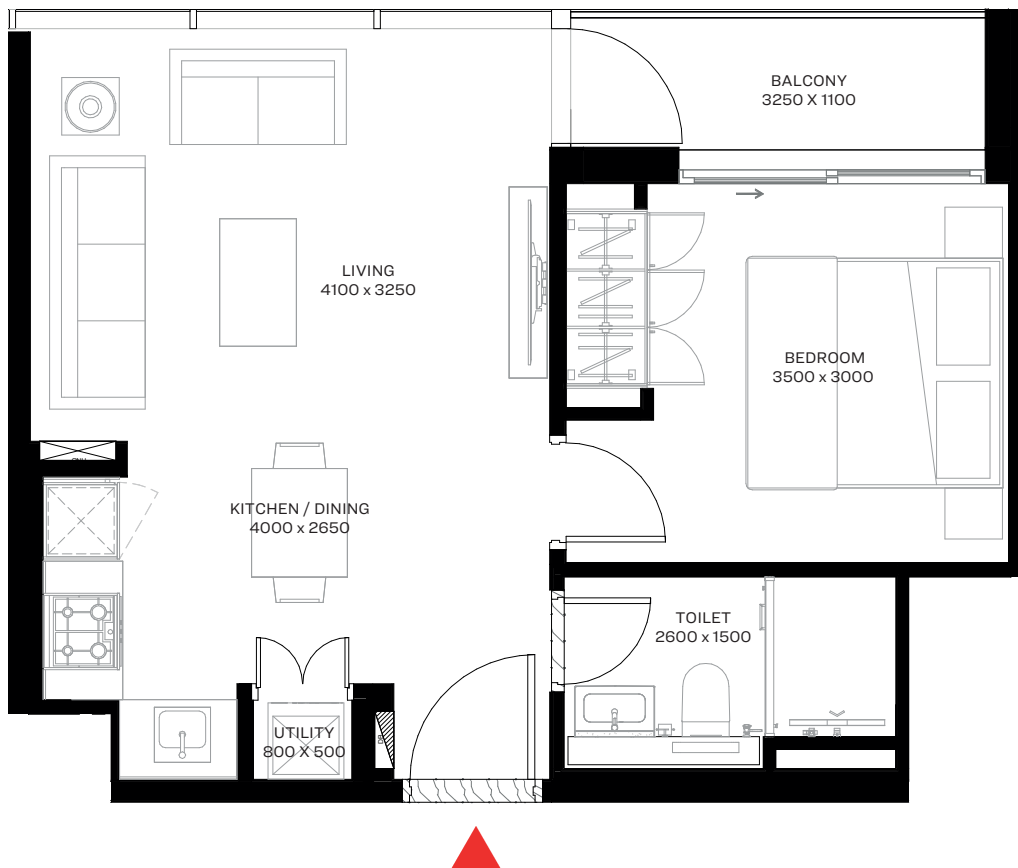

List of unit numbers with this unit plan:

VIEWS

Amenities
D0702



2 BEDROOM APARTMENT

TYPE A (with maid room + balcony)

TOTAL SALEABLE AREA

SIZE = 1,106.10 SQ.FT.

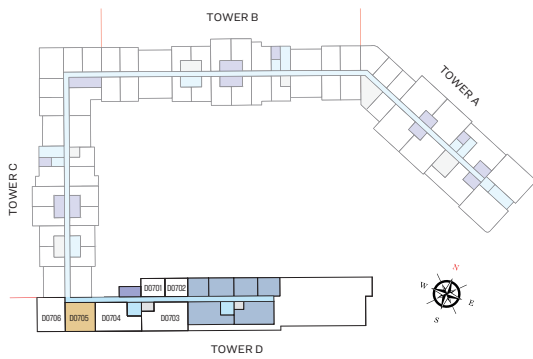

LEVEL-07

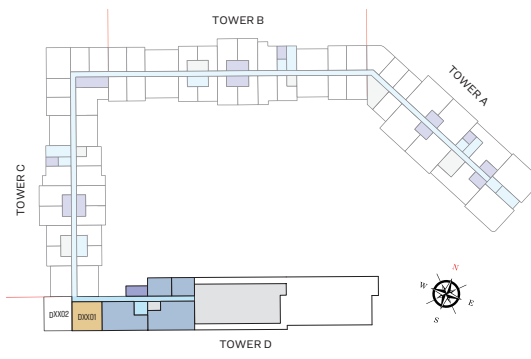

LEVEL-08 & 09

UNIT

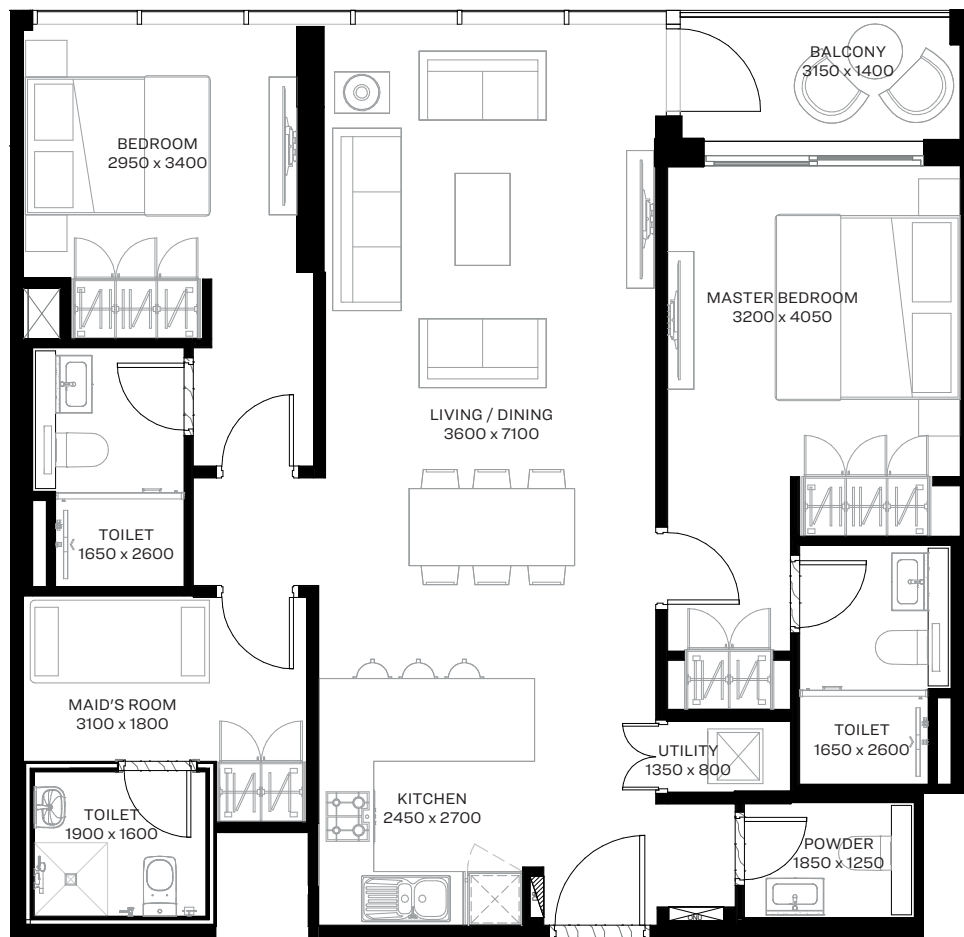

List of unit numbers with this unit plan:

VIEWS

Waterfront
D0705, D0801, D0901



2 BEDROOM APARTMENT

TYPE B (with maid room + balcony)

TOTAL SALEABLE AREA

SIZE RANGE = 1,240.43 SQ.FT. - 1,240.76 SQ.FT.

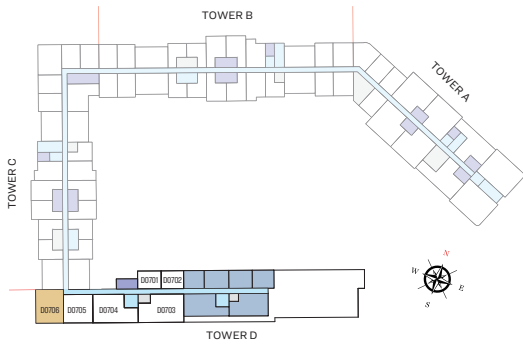

LEVEL-07

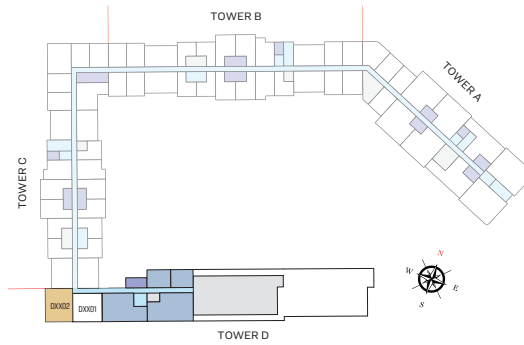

LEVEL-08&09

UNIT

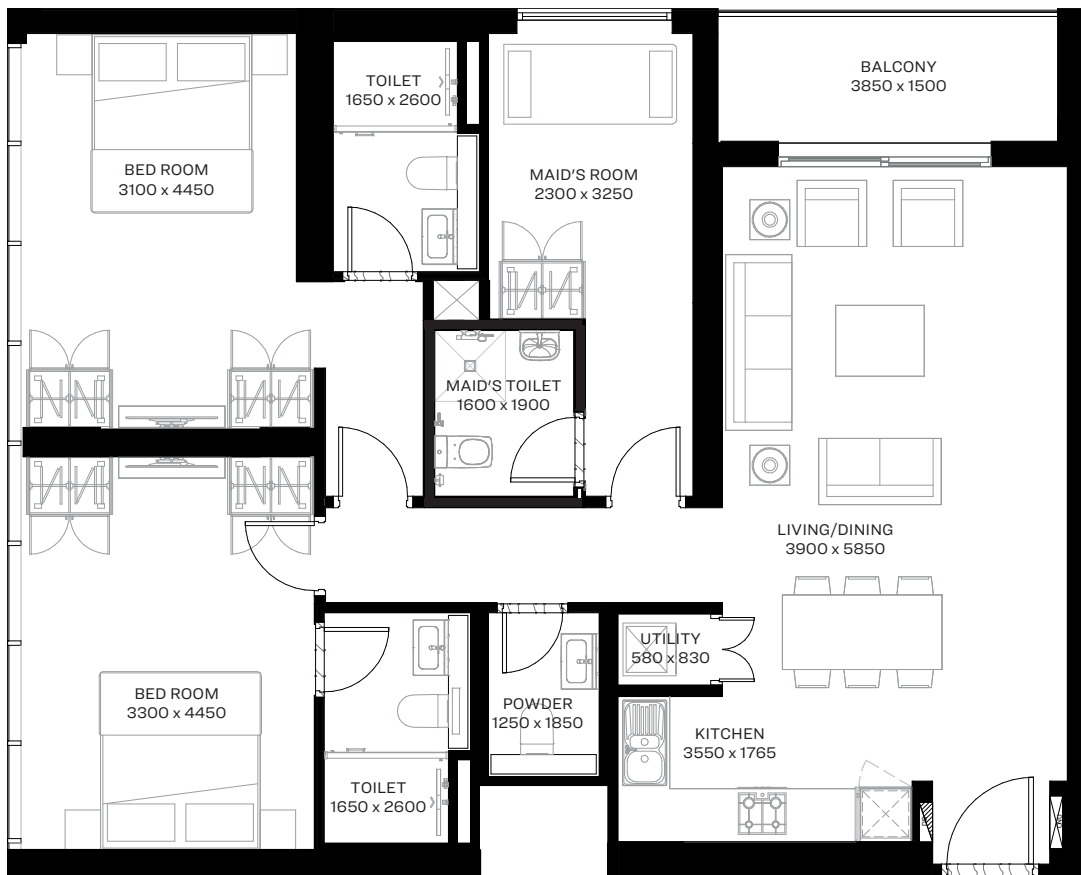

List of unit numbers with this unit plan:

VIEWS

Waterfront
D0706, D0802, D0902



3 BEDROOM APARTMENT

TYPE A (with maid room + balcony)

TOTAL SALEABLE AREA

SIZE RANGE = 1,467.55 SQ.FT. - 1,482.94 SQ.FT.

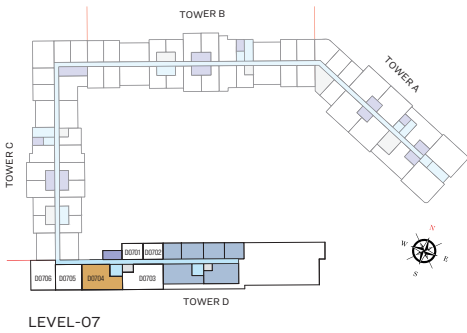
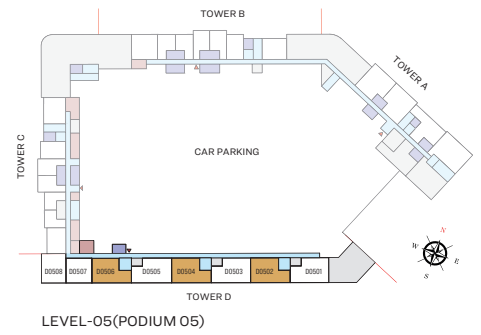
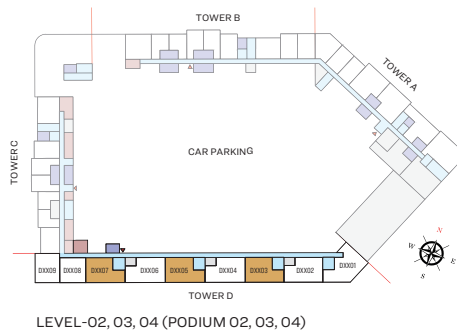
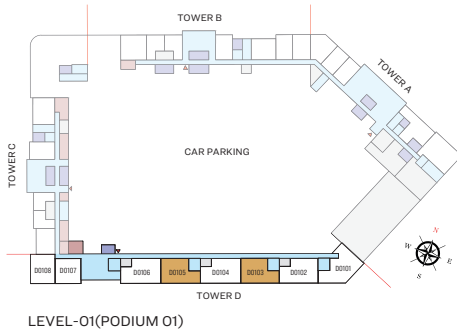

UNIT

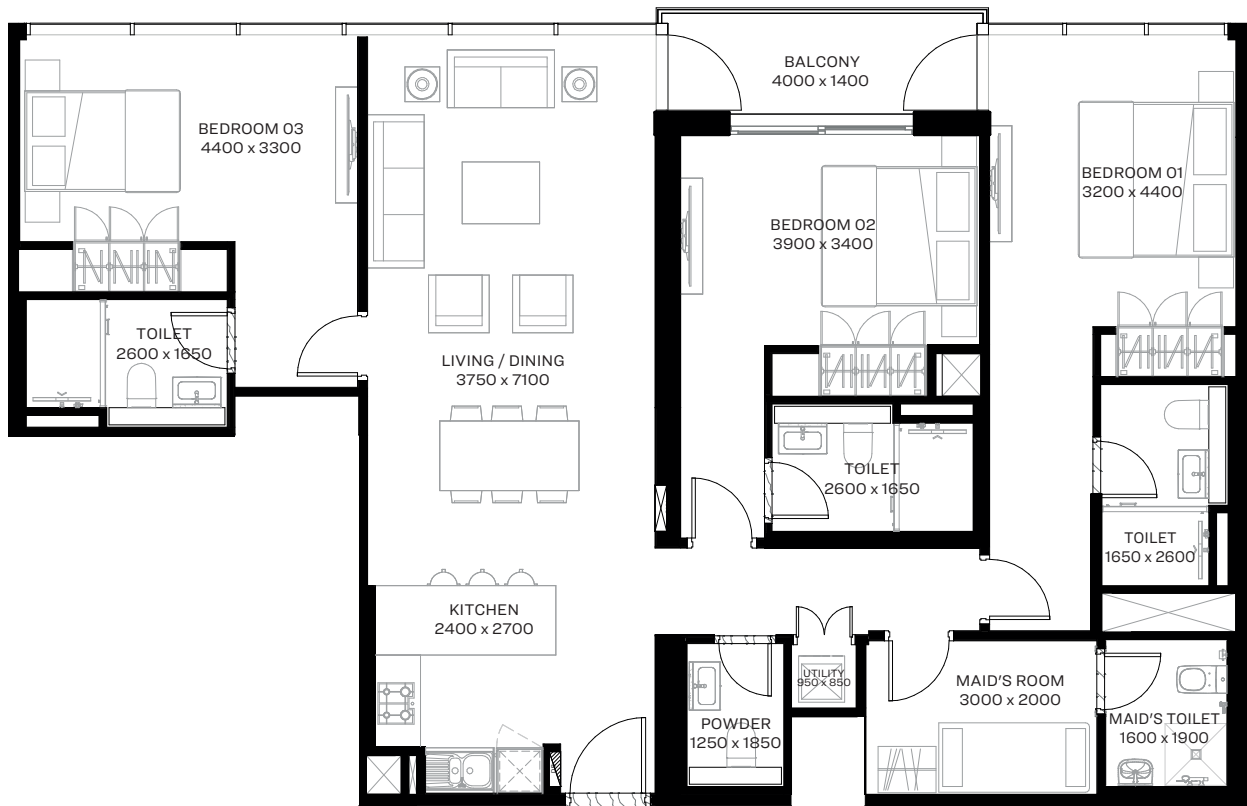

List of unit numbers with this unit plan:

VIEWS

Waterfront

D0103, D0105, D0203, D0205, D0207, D0303, D0305, D0307, D0403, D0405, D0407, D0502, D0504, D0506, D0704



3 BEDROOM APARTMENT

TYPE C (with maid room + balcony)

TOTAL SALEABLE AREA

SIZE RANGE = 1,561.63 SQ.FT. - 1,584.23 SQ.FT.

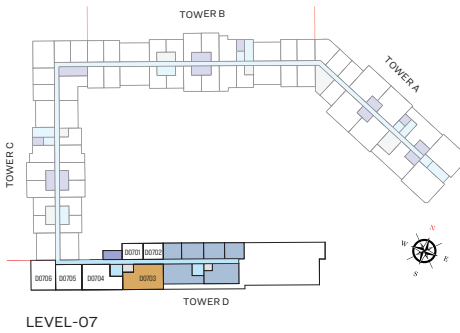
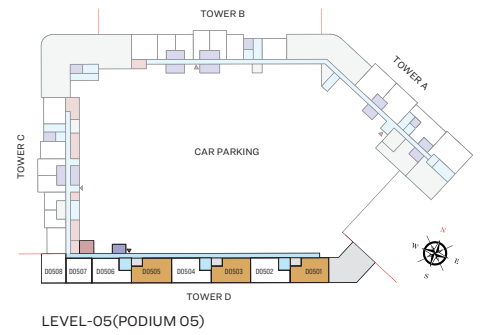
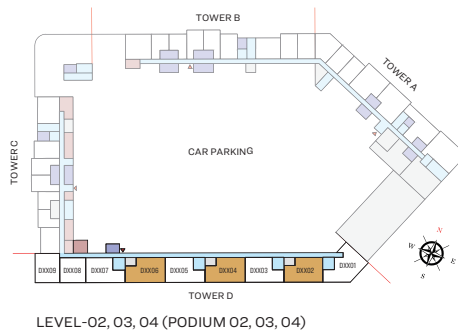
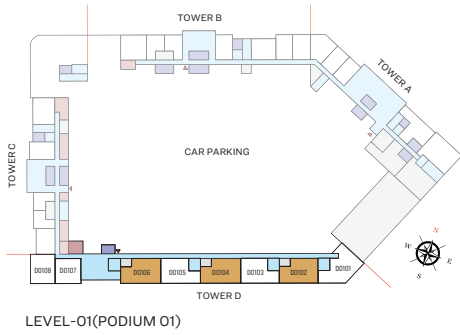

UNIT



List of unit numbers with this unit plan:

VIEWS

Waterfront

D0102, D0104, D0106, D0202, D0204, D0206, D0302, D0304, D0306, D0402, D0404, D0406, D0501, D0503, D0505, D0703



3 BEDROOM APARTMENT

TYPE D (with maid room + balcony)

TOTAL SALEABLE AREA

SIZE RANGE = 1,696.72 SQ.FT. - 1,706.83 SQ.FT.

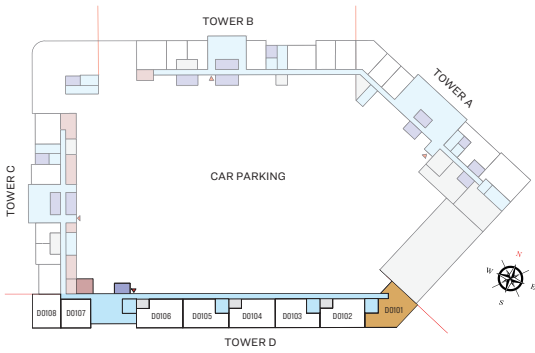

LEVEL-01 (PODIUM 01)

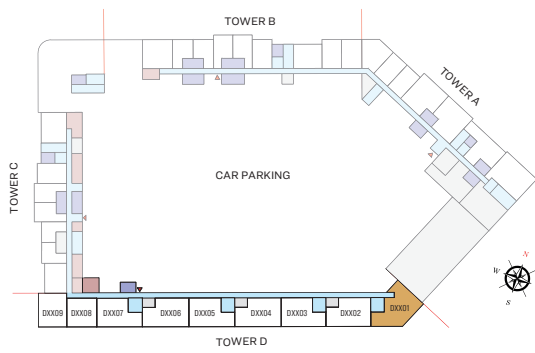

LEVEL-02, 03, 04 (PODIUM 02, 03, 04)

UNIT



List of unit numbers with this unit plan:

VIEWS

Waterfront

D0101, D0201, D0301, D0401



FLOOR PLAN LAYOUT

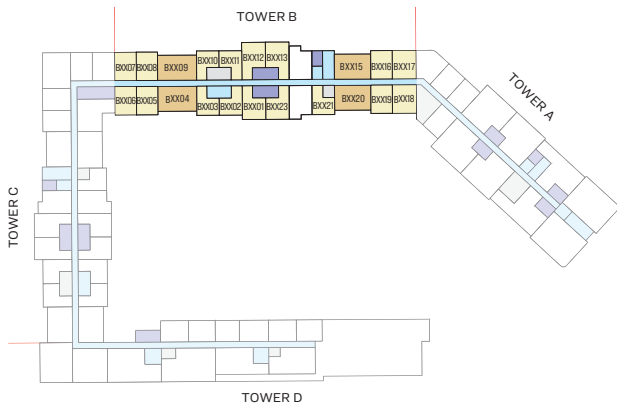
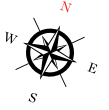

LEVEL 07-12

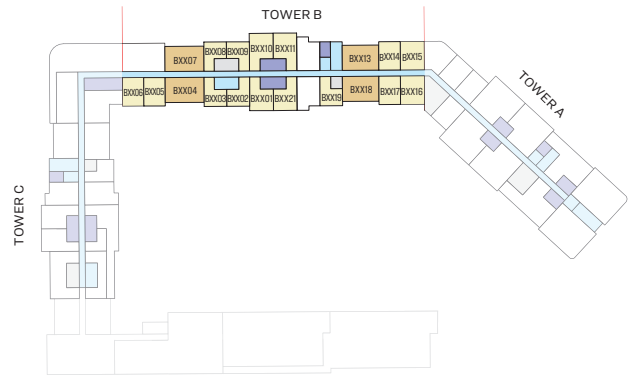

LEVEL 13-16

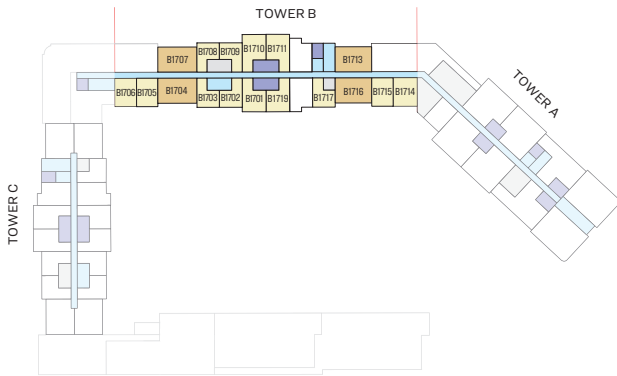

LEVEL 17

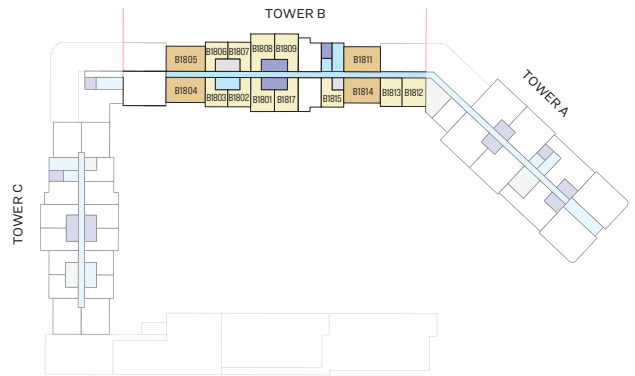

LEVEL 18

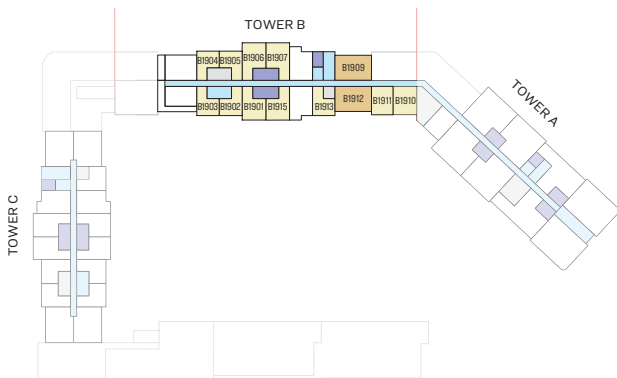

LEVEL 19

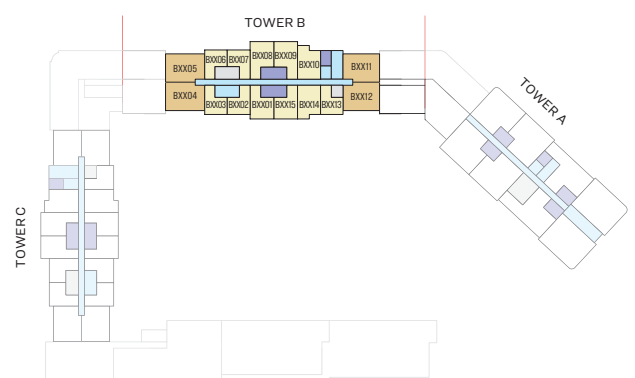

LEVEL 25-38

- 1 BED UNIT
- 2 BED UNIT
- LOBBIES, CORRIDORS & STAIRS
- SERVICES
- LIFT

1 BEDROOM APARTMENT

TYPE B (with balcony)

TOTAL SALEABLE AREA

SIZE RANGE = 511.29 SQ.FT. - 519.47 SQ.FT.

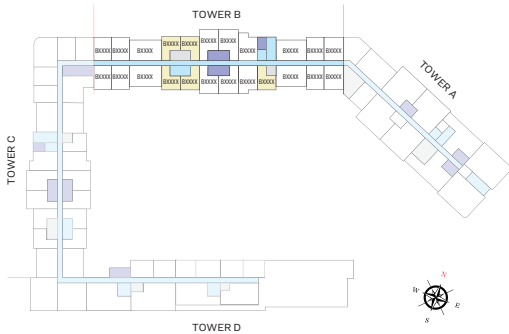

LEVEL 07 - 19

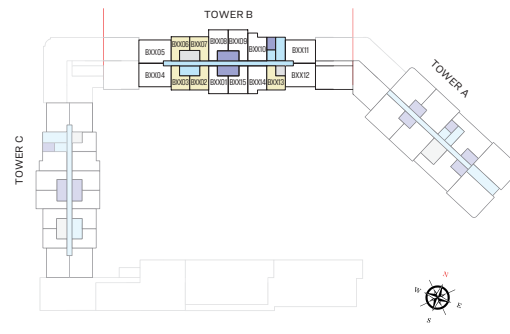

LEVEL 25-38

UNIT

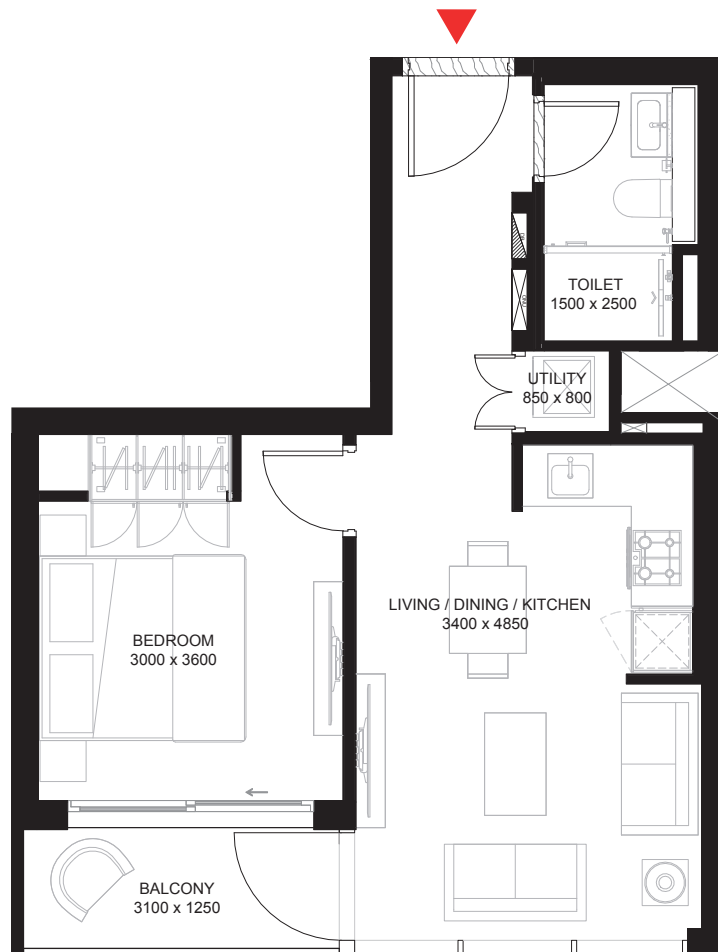

List of unit numbers with this unit plan:

VIEWS

Amenities

B0702, B0703*, B0721*, B0802, B0803*, B0821*, B0902, B0903*, B0921*, B1002, B1003*, B1021*, B1102, B1103*, B1121*, B1202, B1203*, B1221*, B1302, B1303*

Hartland

B0710*, B0711*, B0810*, B0811*, B0910*, B0911*

Downtown, BK, Hartland, Ras Al Khor

B1508*, B1509*, B1608*, B1609*, B1708*, B1709*, B1806*, B1807*, B1904*, B1905*, B2506*, B2507*, B2606*, B2607*, B2706*, B2707*, B2806*, B2807*, B2906*, B2907*, B3006*, B3007*, B3106*, B3107*, B3206*, B3207*, B3306*, B3307*, B3406*, B3407*, B3506*, B3507*, B3606*, B3607*, B3706*, B3707*, B3806*, B3807*

Hartland, Ras Al Khor

B1010*, B1011*, B1110*, B1111*, B1210*, B1211*, B1308*, B1309*, B1408*, B1409*

Amenities, Waterfront

B1319*, B1402, B1403*, B1419*, B1502, B1503*, B1519*, B1602, B1603*, B1619*, B1702, B1703*, B1717*, B1802, B1803*, B1815*, B1902, B1903*, B1913*, B2502, B2503*, B2513*, B2602, B2603*, B2613*, B2702, B2703, B2713*, B2802, B2803*, B2813*, B2902, B2903*, B2913*, B3002, B3003*, B3013*, B3102, B3103*, B3113*, B3202, B3203*, B3213*, B3302, B3303*, B3313*, B3402, B3403*, B3413*, B3502, B3503*, B3513*, B3602, B3603*, B3613*, B3702, B3703*, B3713*, B3802, B3803*, B3813*

* These apartments have mirrored units plans of the above

1 BEDROOM APARTMENT

TYPE A (with powder room + balcony)

TOTAL SALEABLE AREA

SIZE RANGE = 572.42 SQ.FT. - 589.22 SQ.FT.

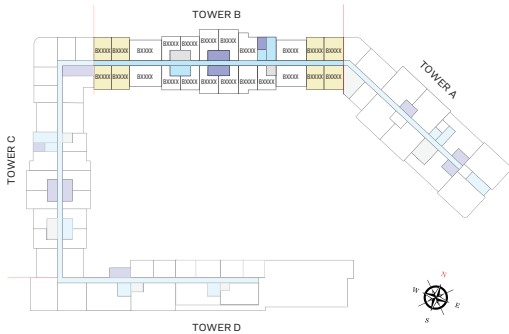

LEVEL 07 - 19

UNIT

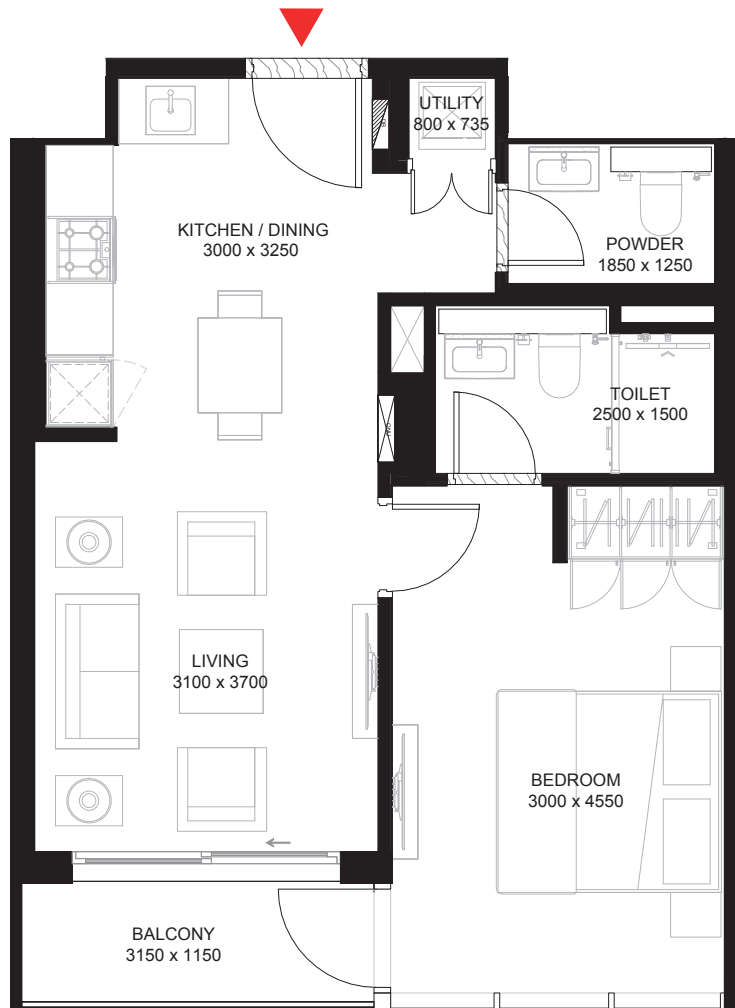

List of unit numbers with this unit plan:

VIEWS

Amenities

B0705, B0706*, B0718, B0719*, B0805, B0806*, B0818, B0819*, B0905, B0906*, B0918, B0919*, B1005, B1006*, B1018, B1019*, B1105, B1106*, B1118, B1119, B1205, B1206*, B1218, B1219*, B1305, B1306*

Downtown, BK, Hartland, Ras Al Khor
B1514*, B1515*, B1614*, B1615*

Downtown, Hartland, Ras Al Khor
B0716*, B0717*, B0816*, B0817*, B0916*, B0917*, B1016*, B1017*, B1116*, B1117*, B1216*, B1217*, B1314*, B1315*, B1414*, B1415*

Hartland

B0707*, B0708*, B0807*, B0808*, B0907*, B0908*

Hartland, Ras Al Khor

B1007*, B1008*, B1107*, B1108*, B1207*, B1208*

Amenities, Waterfront

B1316*, B1317*, B1405, B1406*, B1416, B1417*, B1505, B1506*, B1516, B1517*, B1605, B1606*, B1616, B1617*, B1705, B1706*, B1714, B1715*, B1812, B1813*, B1910, B1911*

* These apartments have mirrored units plans of the above

1 BEDROOM APARTMENT

TYPE A (with study room + balcony)

TOTAL SALEABLE AREA

SIZE RANGE = 678.34 SQ.FT. - 684.48 SQ.FT.

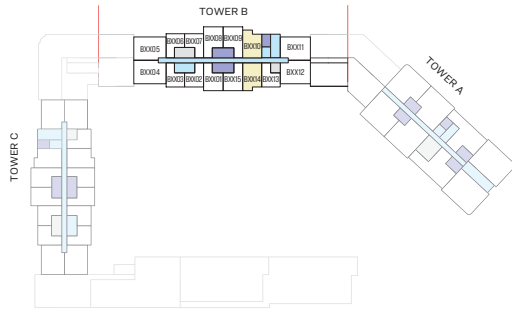

LEVEL 25-38

UNIT

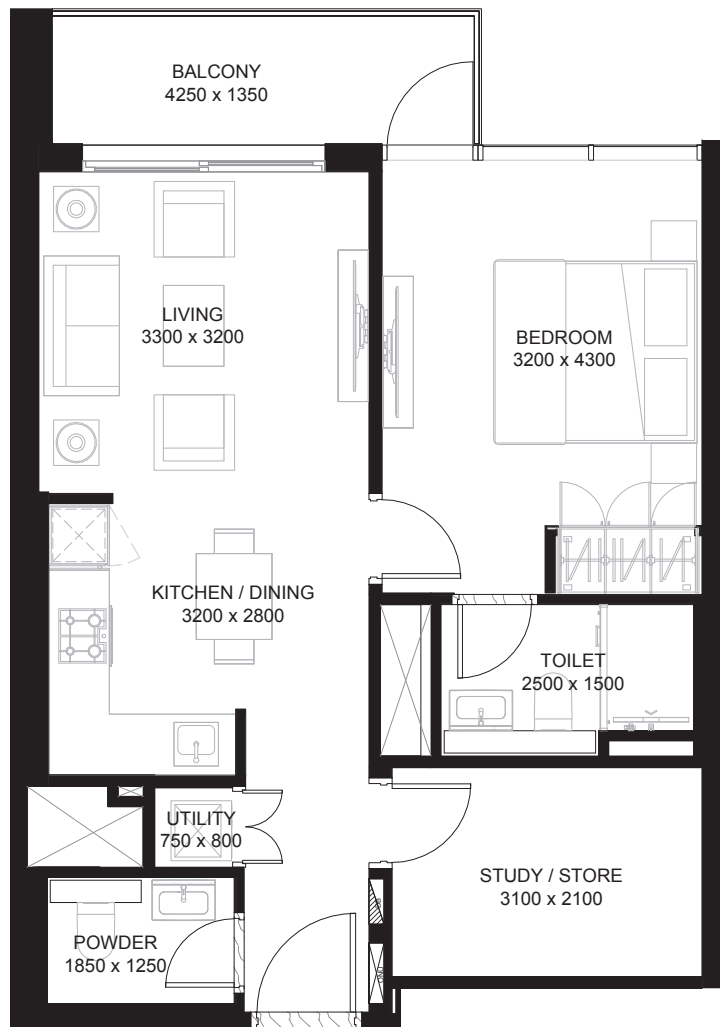

List of unit numbers with this unit plan:

VIEWS

Downtown, BK, Hartland, Ras Al Khor
 B2510, B2610, B2710, B2810, B2910, B3010, B3110, B3210, B3310, B3410, B3510, B3610, B3710, B3810

Amenities, Waterfront
 B2514*, B2614*, B2714*, B2814*, B2914*, B3014*, B3114*, B3214*, B3314*, B3414*, B3514*, B3614*, B3714*, B3814*

* These apartments have mirrored units plans of the above

1 BEDROOM APARTMENT

TYPE B (with powder room + balcony)

TOTAL SALEABLE AREA

SIZE RANGE = 590.51 SQ.FT. - 592.77 SQ.FT.

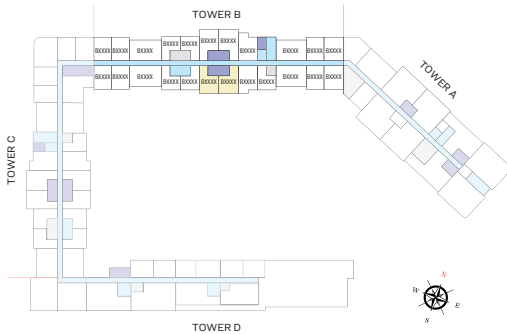

LEVEL 07 - 19

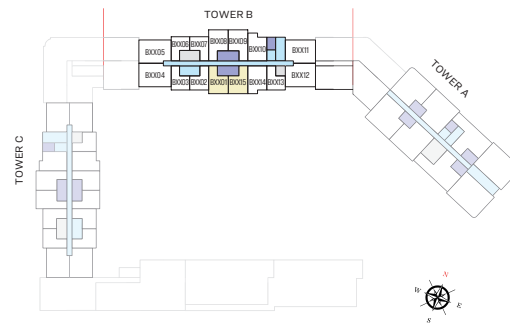

LEVEL 25-38

UNIT

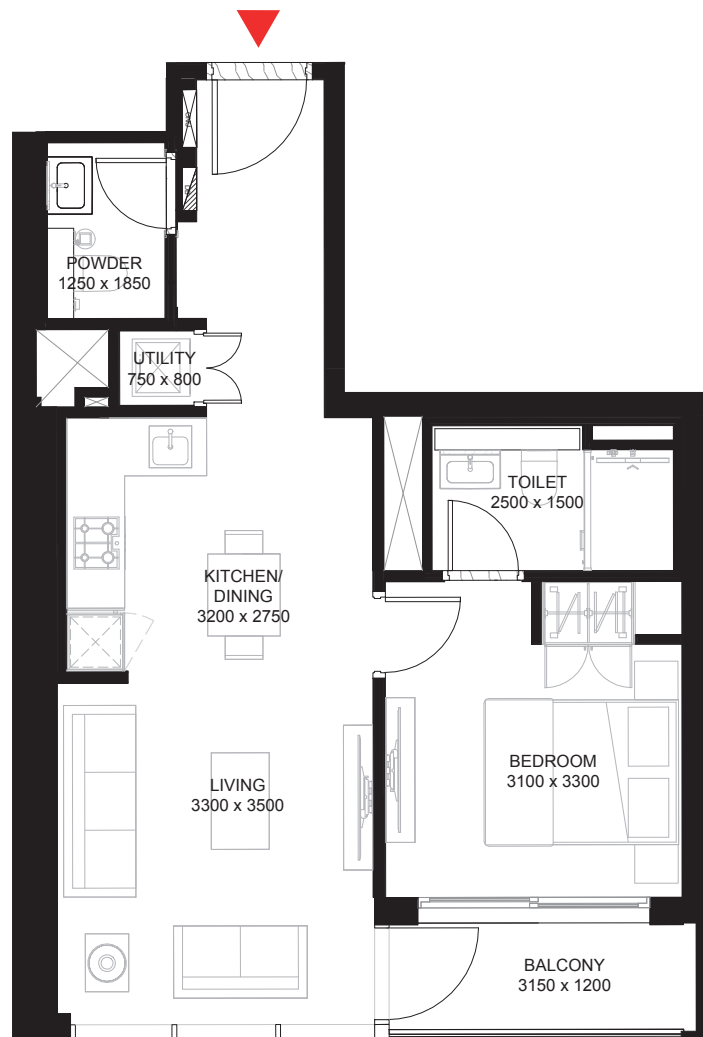

List of unit numbers with this unit plan:

VIEWS

Amenities

B0701, B0723*, B0801, B0823*, B0901, B0923*, B1001, B1023*, B1101, B1123*, B1201, B1223*

Amenities, Waterfront

B1301, B1321*, B1401, B1421*, B1501, B1521*, B1601, B1621*, B1701, B1719*, B1801, B1817*, B1901, B1915*, B2501, B2515*, B2601, B2615*, B2701, B2715*, B2801, B2815*, B2901, B2915*, B3001, B3015*, B3101, B3115*, B3201, B3215*, B3301, B3315*, B3401, B3415*, B3501, B3515*, B3601, B3615*, B3701, B3715*, B3801, B3815*

* These apartments have mirrored units plans of the above

1 BEDROOM APARTMENT

TYPE B (with study room + balcony)

TOTAL SALEABLE AREA

SIZE RANGE = 689.64 SQ.FT. - 692.12 SQ.FT.

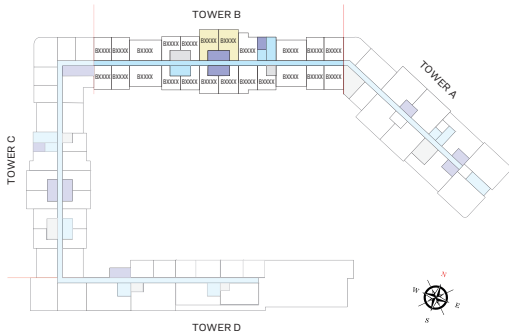

LEVEL 07 - 19

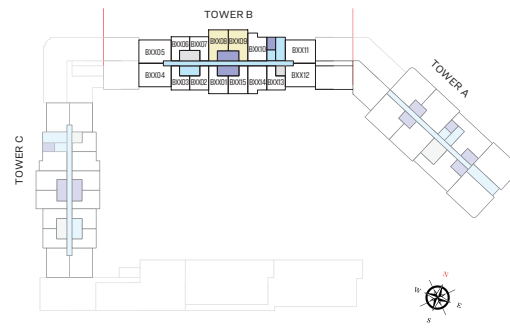

LEVEL 25-38

UNIT

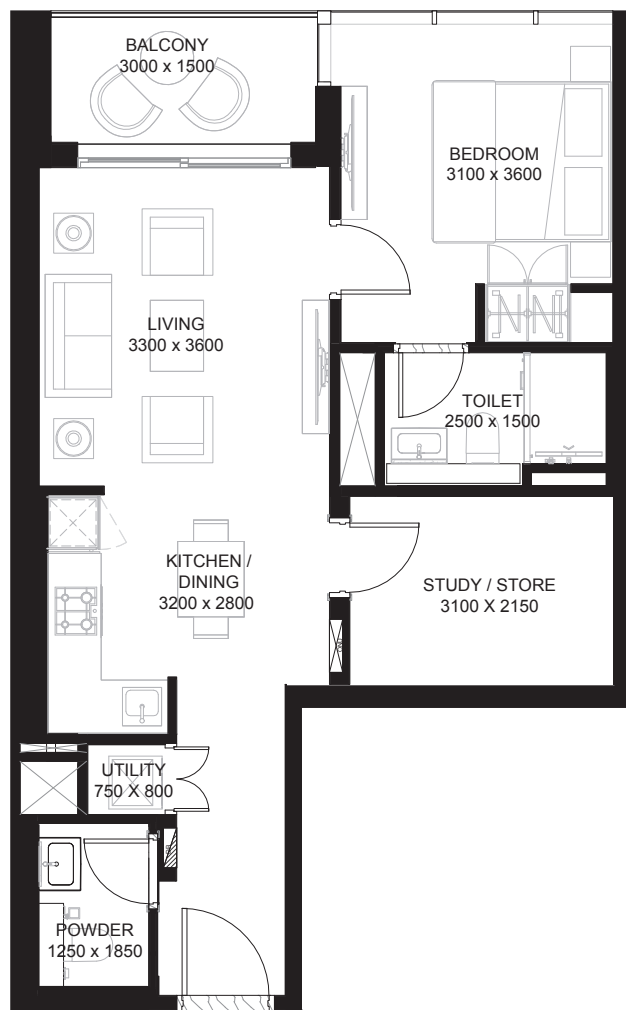

List of unit numbers with this unit plan:

VIEWS

Downtown, BK, Hartland, Ras Al Khor

B1510, B1511*, B1610, B1611*, B1710, B1711*, B1808, B1809*, B1906, B1907*, B2508, B2509*, B2608, B2609*, B2708, B2709*, B2808, B2809*, B2908, B2909*, B3008, B3009*, B3108, B3109*, B3208, B3209*, B3308, B3309*, B3408, B3409*, B3508, B3509*, B3608, B3609*, B3708, B3709*, B3808, B3809*

Downtown, Hartland, Ras Al Khor

B0712, B0713*, B0812, B0813*, B0912, B0913*, B1012, B1013*, B1112, B1113*, B1212, B1213*, B1310, B1311*, B1410, B1411*

* These apartments have mirrored units plans of the above

2 BEDROOM APARTMENT

TYPE A (with balcony)

TOTAL SALEABLE AREA

SIZE RANGE = 808.26 SQ.FT. - 821.93 SQ.FT.

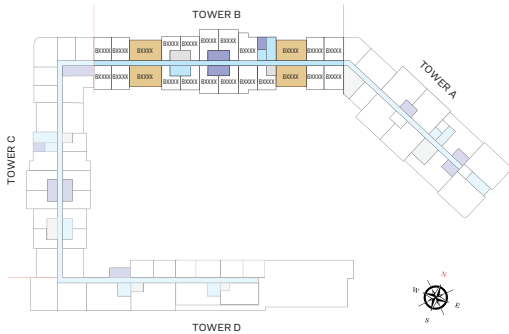

LEVEL 07 - 19

UNIT

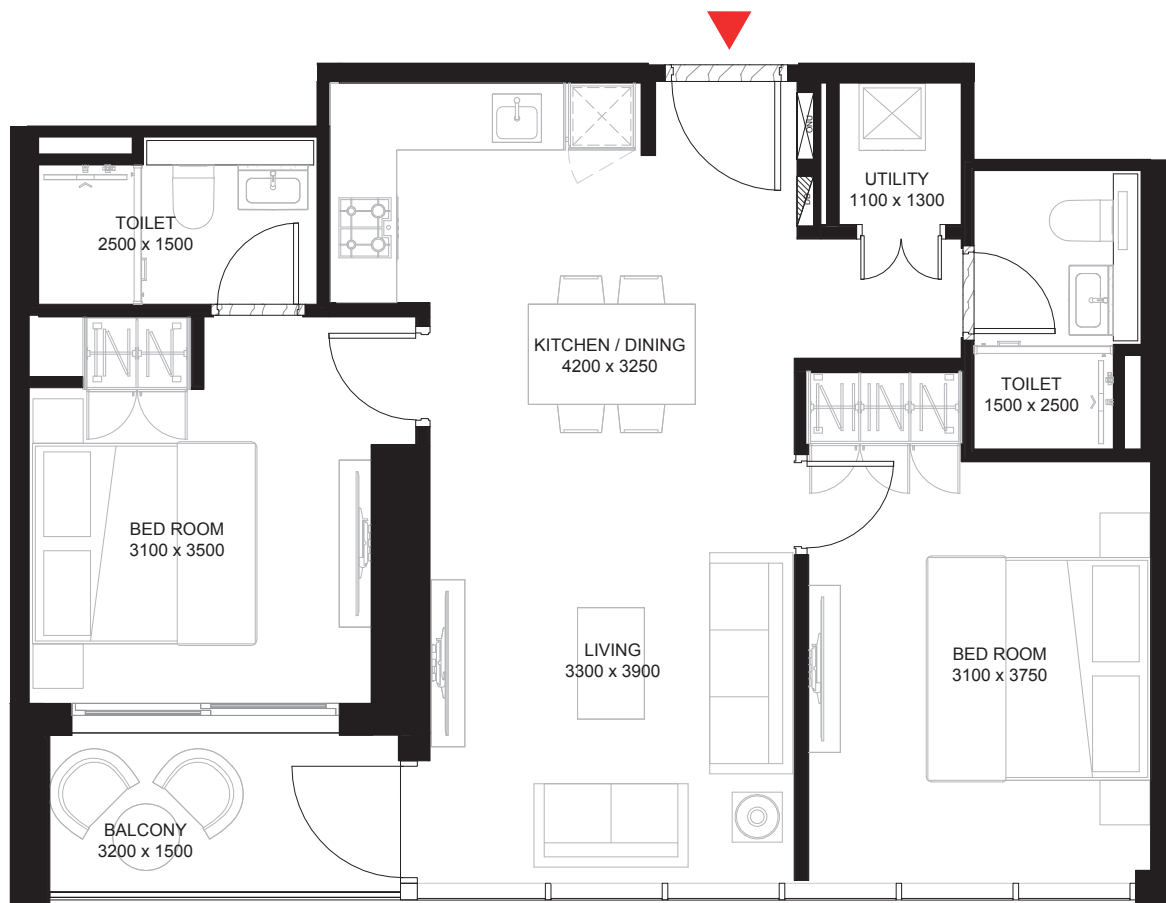

List of unit numbers with this unit plan:

VIEWS

Amenities

B0704, B0720*, B0804, B0820*, B0904, B0920*, B1004, B1020*, B1104, B1120*, B1204, B1220*, B1304

Downtown, BK, Hartland, Ras Al Khor

B1507*, B1513*, B1607*, B1613*, B1707*, B1713*, B1805*, B1811*, B1909*

Downtown, Hartland, Ras Al Khor

B0715*, B0815*, B0915*, B1015*, B1115*, B1215*, B1313*, B1413*

Hartland

B0709*, B0809*, B0909*

Hartland, Ras Al Khor

B1009*, B1109*, B1209*, B1307*, B1407*

Amenities, Waterfront

B1318*, B1404, B1418*, B1504, B1518*, B1604, B1618*, B1704, B1716*, B1804, B1814*, B1912*

* These apartments have mirrored units plans of the above

2 BEDROOM APARTMENT

TYPE A (with study room + balcony)

TOTAL SALEABLE AREA

SIZE RANGE = 1049.37 sq.ft. – 1053.79 sq.ft.

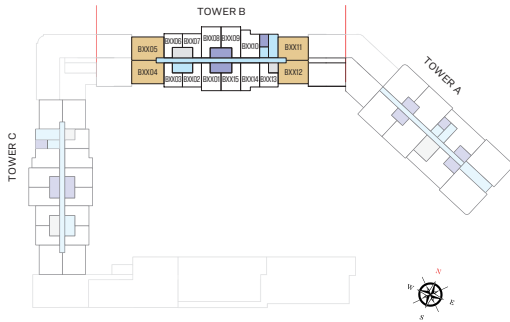

LEVEL 25-38

UNIT

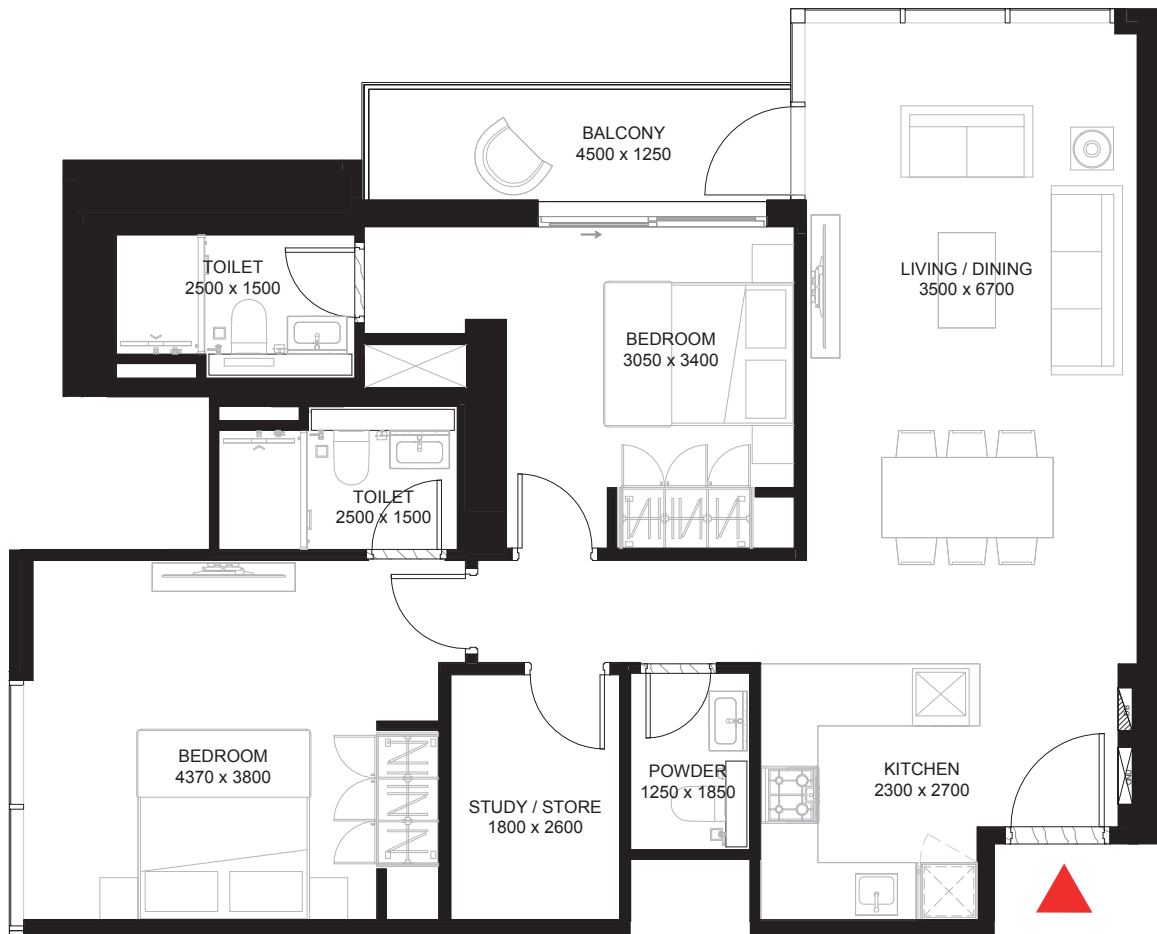

List of unit numbers with this unit plan:

VIEWS

Downtown, BK, Hartland, Amenities, Waterview

B2504*, B2604*, B2704*, B2804*, B2904*, B3004*, B3104*, B3204*, B3304*, B3404*, B3504*, B3604*, B3704*, B3804*

Amenities, Waterview, Ras Al Khor

B2512*, B2612*, B2712*, B2812*, B2912*, B3012*, B3112*, B3212*, B3312*, B3412*, B3512*, B3612*, B3712*, B3812*

Downtown, BK, Hartland, Ras Al Khor

B2505, B2511*, B2605, B2611*, B2705, B2711*, B2805, B2811*, B2905, B2911*, B3005, B3011*, B3105, B3111*, B3205, B3211*, B3305, B3311*, B3405, B3411*, B3505, B3511*, B3605, B3611*, B3705, B3711*, B3805, B3811*

* These apartments have mirrored units plans of the above